

REHABILITATION OF APRON I PCC PANELS

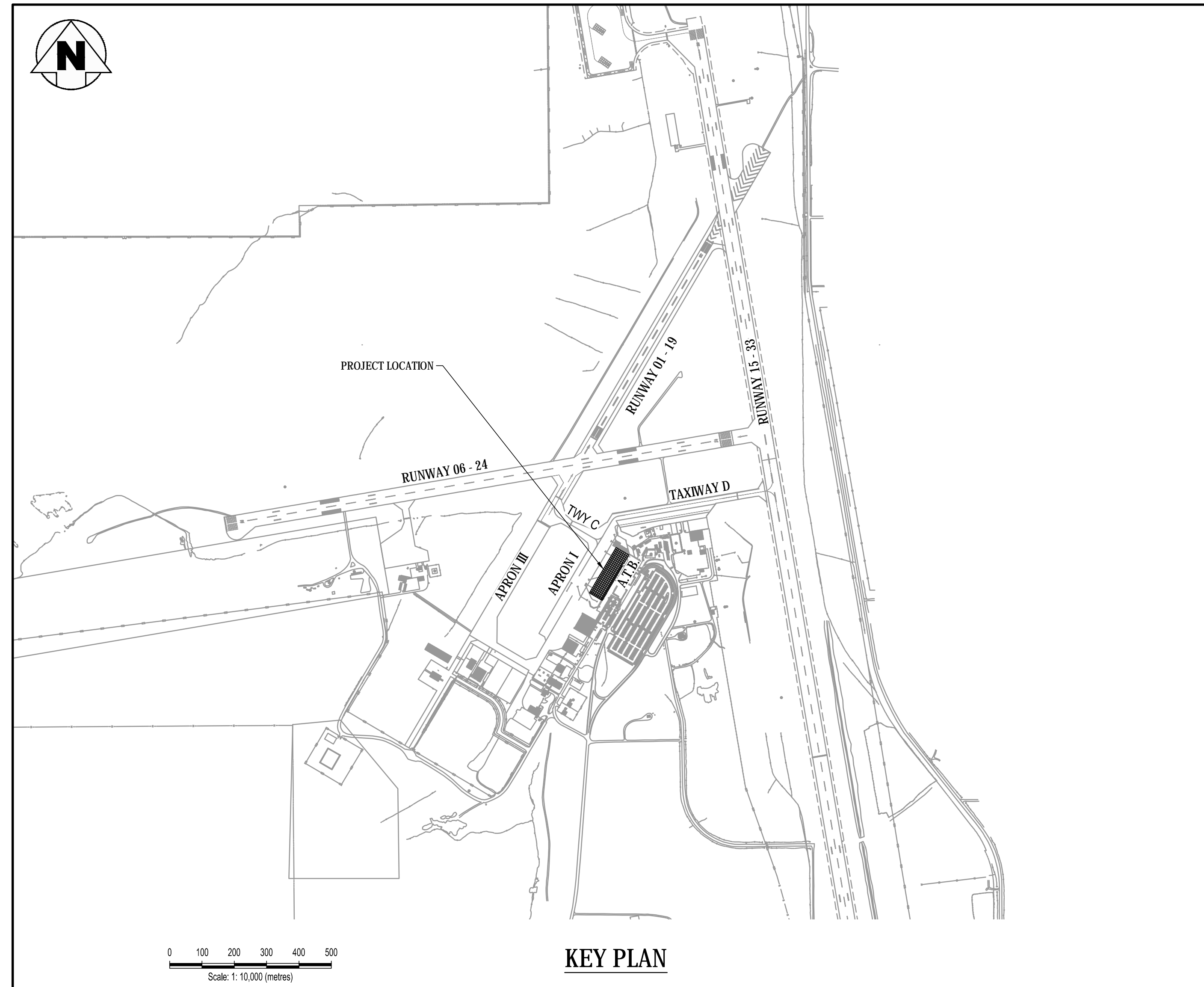

DRAWING LIST

C1.0	SITE PLAN
C2.0	PLAN OF CONSTRUCTION OPERATIONS - SECTION 1
C2.1	PLAN OF CONSTRUCTION OPERATIONS - SECTION 2
C2.2	PLAN OF CONSTRUCTION OPERATIONS - SECTION 3
C2.3	PLAN OF CONSTRUCTION OPERATIONS - SECTION 4
C3.0	CONCRETE PANEL REHABILITATION PLAN
C4.0	CONCRETE PANEL REHABILITATION DETAILS I
C4.1	CONCRETE PANEL REHABILITATION DETAILS II
C5.0	MANHOLE CONCRETE TOP DETAILS
C6.0	PAINT MARKINGS PLAN

ISSUED FOR TENDER

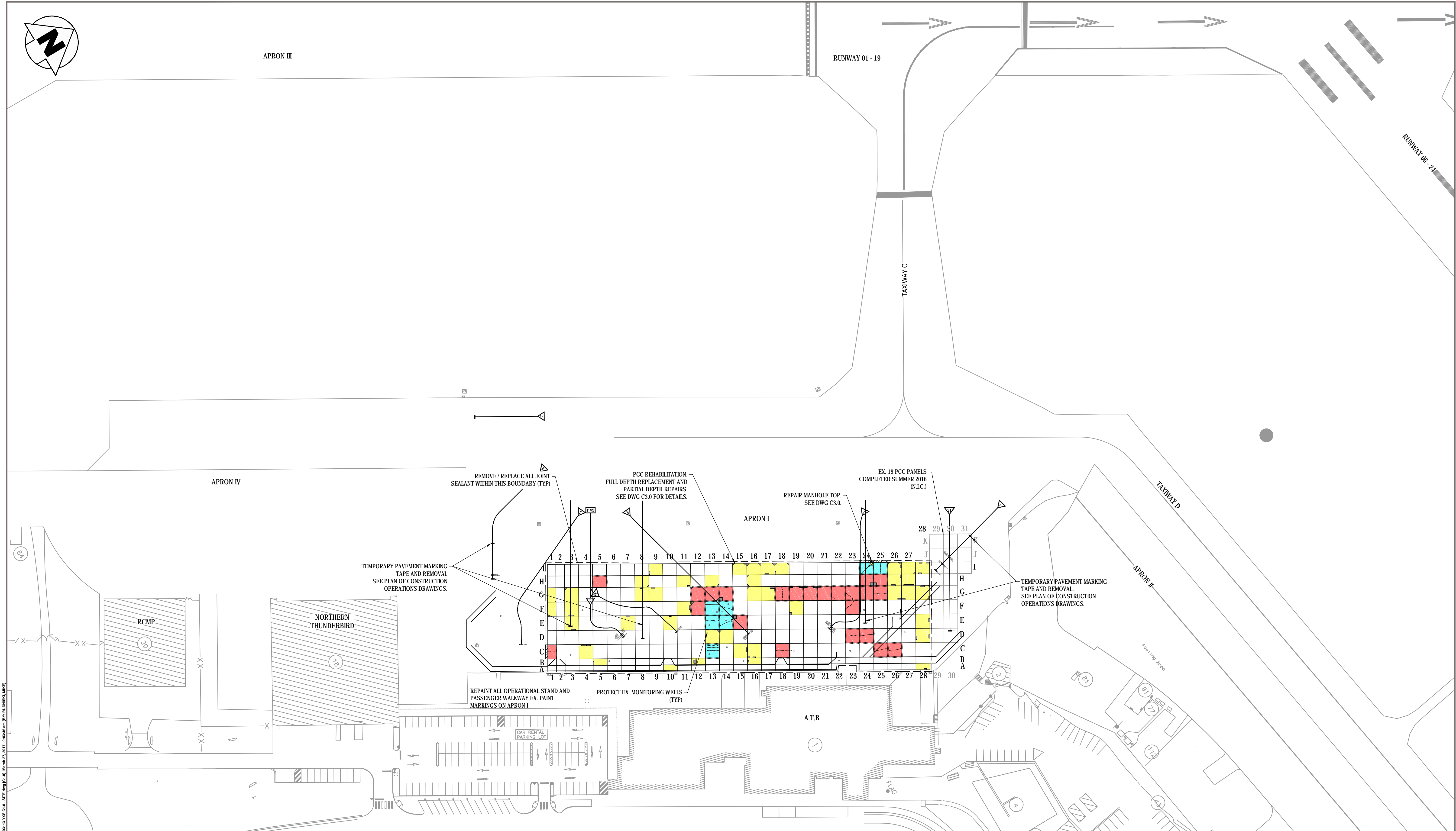
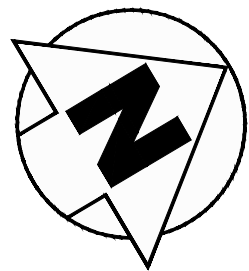

W:\Projects\ELM\WORKING\TRN AIRPORT\13-01\CONSTRUCTION\TRN AIRPORT\13-01 SITE.dwg (C1.0) March 27, 2017 - 9:06:48 am (BY: SUDANSHI, MKE)

LEGEND

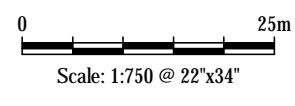

REVISIONS					DRAWING STATUS			
NUM	DATE	DWN	CKD	APR	DESCRIPTION	PERMIT	PROFESSIONAL SEAL	
0	17/03/27	A.E.	ISSUED FOR TENDER					

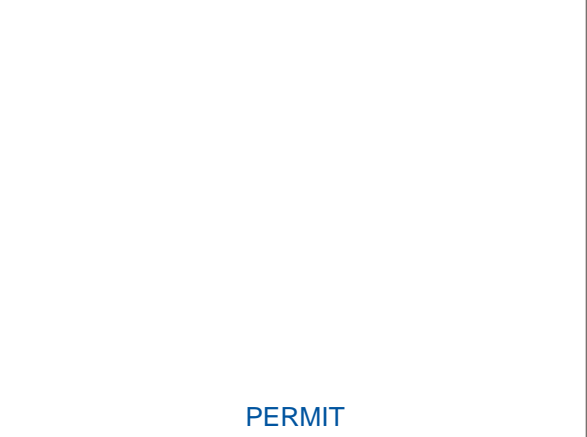

PROFESSIONAL SEAL

CLIENT				
REHABILITATION OF APRON I PCC PANELS				
SITE PLAN				
PROJECT No. TRN AIRP0313-01.001	OFFICE Kelowna	DES K.S.A.	CKD K.S.A.	REV 0
DATE October 31, 2016	SHEET No. 1 of 10	DWN M.E.R.	APP A.E.	STATUS IFT
				C1.0

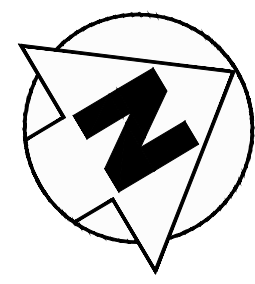

APRON IV

B1900

SUPPLY, INSTALL AND MAINTAIN 150mm WIDE x 4m LONG TEMPORARY BLACK PAVEMENT MARKING TAPE x's OVER OP- STAND DESIGNATOR NUMBER FOR TEMPORARY CLOSURES (TYP) (REMOVE TEMP. TAPE WHEN SECTION COMPLETE)

SAAB 340 W/ 3.0m WINGTIP CLEARANCE

CONTRACTOR'S ESCORTED ACCESS ROUTE FOR SECTION 1. CONTRACTOR TO MAINTAIN CLEAN FOD-FREE CONSTRUCTION ROUTES AT ALL TIMES.

SECTION 1

18 19 20 21 22 23 24 25 26 27 28 29 30

APRON I

SAAB 340 W/ 3.0m WINGTIP CLEARANCE

B1900 W/ 3.0m WINGTIP CLEARANCE

SUPPLY, INSTALL AND MAINTAIN 150mm WIDE x 1.5m LONG TEMPORARY YELLOW PAVEMENT MARKING TAPE AT TEMP. STOP BAR LOCATION FOR AIRCRAFT SHOWN IN MATRIX BELOW DURING SECTION 1 CONSTRUCTION. (REMOVE TEMP. TAPE WHEN SECTION COMPLETE)

RCMP

NORTHERN THUNDERBIRD

B737-800W W/ 4.5m WINGTIP CLEARANCE

Q400 W/ 4.5m WINGTIP CLEARANCE

A.T.B.

RELOCATE TEMP. FENCING TO ENCLOSE PANEL A28 AS REQUIRED TO MINIMIZE DISRUPTION TO PASSENGER WALKWAY. PROVIDE SAFE UNIMPEDED PASSENGER ACCESS AT ALL TIMES.

RESTRICTIONS	OP- STAND #	BCH 1900D	BCH 1900E	SAAB 340	B737-700	B737-800	B737-700W	B737-800W	B737-300ER	A321XLR	CONVERSE 300
SEE NOTE 1	1	●	●	●	●	●	●	●	●	●	●
SEE NOTE 2	1A	●	●	●	●	●	●	●	●	●	●
SEE NOTE 2	2	●	●	●	●	●	●	●	●	●	●
SEE NOTE 3	3	●	●	●	●	●	●	●	●	●	●
SEE NOTE 4	3A	●	●	●	●	●	●	●	●	●	●
SEE NOTE 3 AND 5	4	●	●	●	●	●	●	●	●	●	●
SEE NOTE 6	5	●	●	●	●	●	●	●	●	●	●
SEE NOTE 7	6	●	●	●	●	●	●	●	●	●	●
SEE NOTE 7	7	●	●	●	●	●	●	●	●	●	●

RESTRICTIONS NOTES:
 1. OPSTAND 1 IS RESTRICTED TO TEMPORARY STOP BAR AS NOTED IN TABLE.
 2. OPSTANDS 1A AND 2 ARE CLOSED DURING SECTION 1 CONSTRUCTION.
 3. OPSTANDS 3 AND 4 ARE CLOSED WHEN OPSTAND 3A IS IN USE.
 4. OPSTAND 3A IS CLOSED WHEN OPSTANDS 3 AND 4 ARE IN USE.
 5. B737-800W CANNOT BE ON OPSTAND 4 WHEN OPSTAND 5 IS IN USE.
 6. OPSTAND 5 IS CLOSED WHEN SAAB 340 OR DORNIER 328 ARE ON OPSTAND 6, AND OR B737-800W IS ON OPSTAND 4.
 7. OPSTAND 6 IS RESTRICTED TO BCH-1900D WHEN OPSTAND 5 IS IN USE.

GENERAL REQUIREMENTS:

OPERATIONAL REQUIREMENTS

- CONTRACTOR SHALL CONTROL AND BE RESPONSIBLE FOR CONTRACTOR'S PERSONNEL / SUBCONTRACTORS.
- ALL CONTRACTOR'S VEHICLES REQUIRED ON AIRSIDE FOR CONSTRUCTION ACTIVITIES SHALL BE EQUIPPED WITH 360 DEGREE FLASHING AMBER BEACON.
- ALL CONTRACTOR'S PERSONNEL / SUB-CONTRACTORS ARE REQUIRED TO HAVE TEMPORARY RESTRICTED AREA PASSES WHILE ON AIRSIDE.
- AIRSIDE ESCORT (A.E.) WILL BE PROVIDED BY THE AIRPORT. IT IS THE CONTRACTOR'S RESPONSIBILITY TO COORDINATE AND SCHEDULE THE A.E. PROVIDE 72 HOURS NOTICE FOR SCHEDULING THE A.E. CONTACT THE PRINCE GEORGE AIRPORT'S SECURITY OFFICE.
- CONTRACTOR SHALL PROVIDE THE ACCESS CONTROL GUARD (ACG). ACG IS REQUIRED FOR ALL TIMES THE AIRSIDE ACCESS GATE IS UNLOCKED. THE PRINCE GEORGE AIRPORT WILL PROVIDE TRAINING FOR THE CONTRACTOR'S ACG'S PRIOR TO COMMENCEMENT OF CONSTRUCTION.
- CONTRACTOR'S CONSTRUCTION SAFETY SHALL MEET WORKSAFE BC REGULATIONS AND ADVISE AND PROTECT PERSONNEL FROM NOISE AND POTENTIAL JET BLAST / PROW WASH OF ACTIVE AIRCRAFT OPERATIONS.
- ALL AIRPORT PAVEMENT SURFACES TO BE KEPT CLEAN OF CONSTRUCTION DEBRIS AND F.O.D. CONTRACTOR IS RESPONSIBLE TO MAINTAIN & PROVIDE CLEAN PAVEMENT SURFACES.
- NO SMOKING ALLOWED ON AIRSIDE.
- ALL F.O.D. POTENTIAL ITEMS AND GARBAGE MUST BE CONTAINED TO PREVENT FLYAWAY AND THEN DISPOSED OFF-SITE AT THE END OF EACH WORK SHIFT.
- CONTRACTOR TO ARRANGE FOR SHUT DOWN AND LOCKOUT ELECTRICAL SYSTEMS PRIOR TO ANY SUBSURFACE WORK WITHIN 5M OF AIRPORT ELECTRICAL INFRASTRUCTURE. CONTRACTOR MUST RECEIVE PRIOR APPROVAL FROM THE AIRPORT IN ORDER TO SHUT DOWN ANY AIRPORT ELECTRICAL FACILITIES. CONTRACTOR MUST COORDINATE WITH THE AIRPORT'S ELECTRICAL CONTRACTOR IN ORDER TO SCHEDULE ANY ELECTRICAL CIRCUIT SHUTDOWNS AND START-UPS THAT MAY AFFECT ANY AIRPORT ELECTRICAL OR COMMUNICATION FACILITIES.
- ANY INTERRUPTION OF ELECTRICAL SYSTEMS OR NAVIGATIONAL AIDS REQUIRES A MINIMUM 72 HOURS PRIOR NOTICE AND A SPECIFIC NOTAM.
- READ AND COMPLY WITH THE PCO DOCUMENT IN THE SPECIFICATIONS THAT ACCOMPANIES THIS DRAWING.

WORK SECTION 1 - DAYTIME WORK (07:00 - 19:00):

SCOPE OF WORK:

REMOVE EXISTING CONCRETE (FULL DEPTH AND/OR PARTIAL DEPTH) TO SUBGRADE ELEVATIONS, INCLUDING REMOVAL OFF-SITE. CONSTRUCTION OF NEW CONCRETE PANELS OR PARTIAL DEPTH REPAIRS, PARTIAL DEPTH REPAIR OF CONCRETE MANHOLE TOP, AND TEMPORARY TAPE AND PERMANENT PAINT MARKINGS ON APRON I

OPERATIONAL REQUIREMENTS

- INSTALL SECURE, ENCLOSED 1.8M HIGH TEMPORARY MODULOX FENCING AROUND CONSTRUCTION AREA FOR DURATION OF CONCRETE CONSTRUCTION. INSTALL STEADY BURNING RED LIGHTS ON TEMPORARY FENCING. AIRPORT WILL SUPPLY THE SOLAR RED LIGHTS.
- ALL CONTRACTOR'S PERSONNEL / SUBCONTRACTORS SHALL BE ESCORTED BY THE A.E. FOR ALL WORK ON AIRSIDE.
- CONTRACTOR'S PERSONNEL TO BE MADE AWARE OF NORMAL AIRCRAFT AND VEHICLE MOVEMENTS OCCURRING ALONGSIDE THE WORK AREA.

WORK RESTRICTIONS:

- CONTRACTOR MUST CONTROL DUST.
- CONTRACTOR MUST MAINTAIN A CLEAN, FOD FREE CONSTRUCTION SITE AND ACCESS ROUTE.
- NO PILES ALLOWED ABOVE EXISTING GRADES.

AIRPORT OPERATIONAL CHANGES REQUIRED:

- SPECIAL OPERATIONS NOTICE NOTIFYING AIRPORT USERS OF CONSTRUCTION ACTIVITIES ON APRON I
- CLOSURE OF GATES 1A AND 2 FOR THE DURATION OF WORK IN THIS SECTION.
- MAKE GROUND MARSHALLERS AWARE OF CHANGES TO AIRCRAFT PERMITTED AND TEMPORARY STOP BAR LOCATIONS AT GATE 1.

LEGEND:

- TEMPORARY 1.8m HIGH SECURE FENCING C/W RED LIGHTS
- DENOTES AIRCRAFT OP STAND CLOSED 24 / 7 UNTIL SECTION / PHASE IS COMPLETE AND RETURNED TO SERVICE
- CONTRACTOR ESCORTED ACCESS ROUTE

Scale: 1:750 @ 22"x34"

NUM	DATE	DWN	CKD	APR	DESCRIPTION
0	17/03/27				A.E. ISSUED FOR TENDER
REV	DATE	APR			DESCRIPTION

NUM	DATE	DWN	CKD	APR	DESCRIPTION

PERMIT



PROFESSIONAL SEAL

CLIENT



REHABILITATION OF APRON I PCC PANELS

PLAN OF CONSTRUCTION OPERATIONS SECTION 1

PROJECT No. TRN AIRP0313-01.001	OFFICE Kelowna	DES K.S.A.	CKD K.S.A.	REV 0	DRAWING C2.0
DATE: October 31, 2016	SHEET No. 2 of 10	DWN M.E.R.	APP A.E.	STATUS IFT	

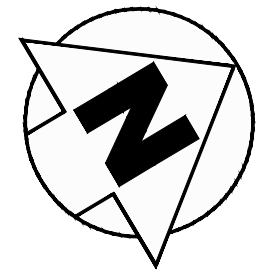

CONTRACTOR'S ESCORTED ACCESS ROUTE FOR SECTIONS 2 - 4.
CONTRACTOR TO MAINTAIN CLEAN FOD-FREE CONSTRUCTION ROUTES AT ALL TIMES.

B737-800W 4.5m WINGTIP CLEARANCE

B737-800W 3.0m MAINGEAR CLEARANCE

SUPPLY, INSTALL AND MAINTAIN 150mm WIDE x 1.5m HIGH TEMPORARY YELLOW OP- STAND DESIGNATOR NUMBER FOR TEMPORARY LEAD-IN LINE. (REMOVE TEMP. TAPE WHEN SECTION COMPLETE)

APRON IV

CODE 'C' TAXIWAY 26m STRIP

SECTION 2

APRON I

SAAB 340 W/ 3.0m WINGTIP CLEARANCE

B1900 W/ 3.0m WINGTIP CLEARANCE

RCMP

NORTHERN THUNDERBIRD

Q400 W/ 4.5m WINGTIP CLEARANCE

RELOCATE TEMP. FENCING TO ENCLOSE PANELS B12 AND B16 AS REQUIRED TO MINIMIZE DISRUPTION TO PASSENGER WALKWAY. PROVIDE SAFE UNIMPEDED PASSENGER ACCESS AT ALL TIMES.

MAINTAIN PEDESTRIAN ACCESS ON HARD SURFACE TO STANDS 4, 5, AND 6.

SUPPLY, INSTALL AND MAINTAIN 150mm WIDE x 52.5m LONG TEMPORARY YELLOW PAVEMENT MARKING TAPE FOR TEMP. LEAD-IN LINE. INSTALL 150mm WIDE x 1.5m LONG TEMPORARY YELLOW PAVEMENT MARKING TAPE AT TEMP. STOP BAR LOCATION FOR AIRCRAFT SHOWN IN MATRIX BELOW DURING SECTION 2 CONSTRUCTION. (REMOVE TEMP. TAPE WHEN SECTION COMPLETE)

GATE 22. CONTRACTOR TO PROVIDE ACCESS CONTROL GUARD FOR ALL TIMES THE GATE IS UNLOCKED.

CONTRACTOR'S ACCESS ROUTE

AIRCRAFT PARKING MATRIX		OP- STAND #	BCH-1900D	DORNER 328	SAAB 340	DSB-400	DH8-300	DH8-400	B737-700W	B737-800W	B737-300ER	A320	A320XLR	CONVENER 900
RESTRICTIONS	1		●	●	●	●	●	●	●	●	●	●	●	●
SEE NOTE 1	1A		●	●	●	●	●	●	●	●	●	●	●	●
	TEMP 2		●	●	●	●	●	●	●	●	●	●	●	●
SEE NOTE 1	2		●	●	●	●	●	●	●	●	●	●	●	●
SEE NOTE 1	3		●	●	●	●	●	●	●	●	●	●	●	●
SEE NOTE 1	3A		●	●	●	●	●	●	●	●	●	●	●	●
	4		●	●	●	●	●	●	●	●	●	●	●	●
SEE NOTE 2	5		●	●	●	●	●	●	●	●	●	●	●	●
SEE NOTE 3	6		●	●	●	●	●	●	●	●	●	●	●	●
	7		●	●	●	●	●	●	●	●	●	●	●	●

RESTRICTIONS NOTES:
1. OPSTANDS 1A, 2, 3 AND 3A ARE CLOSED DURING WORK SECTION 2 CONSTRUCTION.
2. OPSTAND 5 IS CLOSED WHEN SAAB 340 OR DORNER 328 ARE ON OPSTAND 6.
3. OPSTAND 6 IS RESTRICTED TO BCH-1900D WHEN OPSTAND 5 IS IN USE.

WORK SECTION 2 - DAYTIME WORK (07:00 - 19:00):

SCOPE OF WORK:
REMOVE EXISTING CONCRETE (FULL DEPTH AND/OR PARTIAL DEPTH) TO SUBGRADE ELEVATIONS, INCLUDING REMOVAL OFF-SITE, CONSTRUCTION OF NEW CONCRETE PANELS OR PARTIAL DEPTH REPAIRS, AND TEMPORARY TAPE AND PERMANENT PAINT MARKINGS ON APRON I

OPERATIONAL REQUIREMENTS:
1. INSTALL SECURE, ENCLOSED 1.8m HIGH TEMPORARY MODULOK FENCING AROUND CONSTRUCTION AREA FOR DURATION OF CONCRETE CONSTRUCTION. INSTALL STEADY BURNING RED LIGHTS ON TEMPORARY FENCING. AIRPORT WILL SUPPLY THE SOLAR RED LIGHTS.
2. ALL CONTRACTOR'S PERSONNEL / SUBCONTRACTORS SHALL BE ESCORTED BY THE A.E. FOR ALL WORK ON AIRSIDE.
3. CONTRACTOR'S PERSONNEL TO BE MADE AWARE OF NORMAL AIRCRAFT AND VEHICLE MOVEMENTS OCCURRING ALONGSIDE THE WORK AREA.

WORK RESTRICTIONS:
1. CONTRACTOR MUST CONTROL DUST.
2. CONTRACTOR MUST MAINTAIN A CLEAN, FOD FREE CONSTRUCTION SITE AND ACCESS ROUTE.
3. NO PILES ALLOWED ABOVE EXISTING GRADES.

AIRPORT OPERATIONAL CHANGES REQUIRED:
1. SPECIAL OPERATIONS NOTICE NOTIFYING AIRPORT USERS OF CONSTRUCTION ACTIVITIES ON APRON I
2. CLOSURE OF GATES 1A, 2, 3 AND 3A FOR THE DURATION OF WORK IN THIS SECTION.
3. MAKE GROUND MARSHALLERS AWARE OF CHANGES TO AIRCRAFT PERMITTED AND TEMPORARY LEAD-IN LINES / STOP BAR LOCATIONS ON GATE 1A AND TEMPORARY GATE 2.

GENERAL REQUIREMENTS:

OPERATIONAL REQUIREMENTS

- CONTRACTOR SHALL CONTROL AND BE RESPONSIBLE FOR CONTRACTOR'S PERSONNEL / SUBCONTRACTORS.
- ALL CONTRACTOR'S VEHICLES REQUIRED ON AIRSIDE FOR CONSTRUCTION ACTIVITIES SHALL BE EQUIPPED WITH 360 DEGREE FLASHING AMBER BEACON.
- ALL CONTRACTOR'S PERSONNEL / SUB-CONTRACTORS ARE REQUIRED TO HAVE TEMPORARY RESTRICTED AREA PASSES WHILE ON AIRSIDE.
- AIRSIDE ESCORT (A.E.) WILL BE PROVIDED BY THE AIRPORT. IT IS THE CONTRACTOR'S RESPONSIBILITY TO COORDINATE AND SCHEDULE THE A.E. PROVIDE 72 HOURS NOTICE FOR SCHEDULING THE A.E. CONTACT THE PRINCE GEORGE AIRPORT'S SECURITY OFFICE.
- CONTRACTOR SHALL PROVIDE THE ACCESS CONTROL GUARD (ACG). ACG IS REQUIRED FOR ALL TIMES THE AIRSIDE ACCESS GATE IS UNLOCKED. THE PRINCE GEORGE AIRPORT WILL PROVIDE TRAINING FOR THE CONTRACTOR'S ACGS PRIOR TO COMMENCEMENT OF CONSTRUCTION.
- CONTRACTOR'S CONSTRUCTION SAFETY SHALL MEET WORKSAFE BC REGULATIONS AND ADVISE AND PROTECT PERSONNEL FROM NOISE AND POTENTIAL JET BLAST / PROPP WASH OF ACTIVE AIRCRAFT OPERATIONS.
- ALL AIRPORT PAVEMENT SURFACES TO BE KEPT CLEAN OF CONSTRUCTION DEBRIS AND F.O.D. CONTRACTOR IS RESPONSIBLE TO MAINTAIN & PROVIDE CLEAN PAVEMENT SURFACES.
- NO SMOKING ALLOWED ON AIRSIDE.
- ALL F.O.D. POTENTIAL ITEMS AND GARBAGE MUST BE CONTAINED TO PREVENT FLYAWAY AND THEN DISPOSED OFF-SITE AT THE END OF EACH WORK SHIFT.
- CONTRACTOR TO ARRANGE FOR SHUT DOWN AND LOCKOUT ELECTRICAL SYSTEMS PRIOR TO ANY SUBSURFACE WORK WITHIN 5M OF AIRPORT ELECTRICAL INFRASTRUCTURE. CONTRACTOR MUST RECEIVE PRIOR APPROVAL FROM THE AIRPORT IN ORDER TO SHUT DOWN ANY AIRPORT ELECTRICAL FACILITIES. CONTRACTOR MUST COORDINATE WITH THE AIRPORT'S ELECTRICAL CONTRACTOR IN ORDER TO SCHEDULE ANY ELECTRICAL CIRCUIT SHUTDOWNS AND START-UPS THAT MAY AFFECT ANY AIRPORT ELECTRICAL OR COMMUNICATION FACILITIES.
- ANY INTERRUPTION OF ELECTRICAL SYSTEMS OR NAVIGATIONAL AIDS REQUIRES A MINIMUM 72 HOURS PRIOR NOTICE AND A SPECIFIC NOTAM.
- READ AND COMPLY WITH THE PCO DOCUMENT IN THE SPECIFICATIONS THAT ACCOMPANIES THIS DRAWING.

LEGEND:

- TEMPORARY 1.8m HIGH SECURE FENCING C/W RED LIGHTS
- DENOTES AIRCRAFT OP- STAND CLOSED 24 / 7 UNTIL SECTION / PHASE IS COMPLETE AND RETURNED TO SERVICE
- CONTRACTOR ESCORTED ACCESS ROUTE

Scale: 1:750 @ 22"x34"

NUM	DATE	DWN	CKD	APR	DESCRIPTION
0	17/03/27				A.E. ISSUED FOR TENDER
REV	DATE	APR			DESCRIPTION
DRAWING STATUS					

PERMIT

PROFESSIONAL SEAL



CLIENT



REHABILITATION OF APRON I PCC PANELS

PLAN OF CONSTRUCTION OPERATIONS SECTION 2

PROJECT No.	OFFICE	DES	CKD	REV	DRAWING
TRN AIRP03113-01.001	Kelowna	K.S.A.	K.S.A.	0	C2.1
DATE:	SHEET No.	DWN	APP	STATUS	
October 31, 2016	3 of 10	M.E.R.	A.E.	IFT	

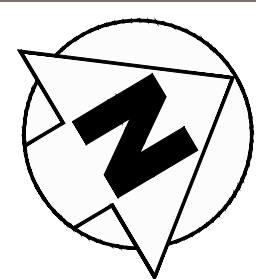

CONTRACTOR'S ESCORTED ACCESS ROUTE FOR SECTIONS 2 - 4. CONTRACTOR TO MAINTAIN CLEAN FOD-FREE CONSTRUCTION ROUTES AT ALL TIMES.

SUPPLY, INSTALL AND MAINTAIN 150mm WIDE x 1.5m HIGH TEMPORARY YELLOW OP-STAND DESIGNATOR NUMBER FOR TEMPORARY LEAD-IN LINE. (REMOVE TEMP. TAPE WHEN SECTION COMPLETE)

SUPPLY, INSTALL AND MAINTAIN 150mm WIDE x 4m LONG TEMPORARY BLACK PAVEMENT MARKING TAPE Xs OVER OP-STAND DESIGNATOR NUMBER FOR TEMPORARY CLOSURES (TYP). (REMOVE TEMP. TAPE WHEN SECTION COMPLETE)

SUPPLY, INSTALL AND MAINTAIN 150mm WIDE x 1.5m LONG TEMPORARY YELLOW PAVEMENT MARKING TAPE AT TEMP. STOP BAR LOCATION FOR AIRCRAFT SHOWN IN MATRIX BELOW DURING SECTION 3 CONSTRUCTION. (REMOVE TEMP. TAPE WHEN SECTION COMPLETE)

SAAB-340 W/ 3.0m WINGTIP CLEARANCE

SUPPLY, INSTALL AND MAINTAIN 150mm WIDE x 53.7m LONG TEMPORARY YELLOW PAVEMENT MARKING TAPE FOR TEMP. LEAD-IN LINE. INSTALL 150mm WIDE x 1.5m LONG TEMPORARY YELLOW PAVEMENT MARKING TAPE AT TEMP. STOP BAR LOCATION FOR AIRCRAFT SHOWN IN MATRIX BELOW DURING SECTION 3 CONSTRUCTION. (REMOVE TEMP. TAPE WHEN SECTION COMPLETE)

Q400 W/ 4.5m WINGTIP CLEARANCE

MAINTAIN PEDESTRIAN ACCESS ON HARD SURFACE TO STANDS 4-7.

RELOCATE TEMP. FENCING TO ENCLOSE PANEL A10 AS REQUIRED TO MINIMIZE DISRUPTION TO PASSENGER WALKWAY. PROVIDE SAFE UNIMPEDED PASSENGER ACCESS AT ALL TIMES.

Q400 W/ 4.5m WINGTIP CLEARANCE

GATE 22. CONTRACTOR TO PROVIDE ACCESS CONTROL GUARD FOR ALL TIMES THE GATE IS UNLOCKED.

CONTRACTOR'S ACCESS ROUTE

AIRCRAFT PARKING MATRIX		OP-STAND #	B737-800W	B737-700W	B737-300W	A320XLR	CONQUEST 300
RESTRICTIONS	OP-STAND #	B737-800W	B737-700W	B737-300W	A320XLR	CONQUEST 300	
1	1A	●	●	●	●	●	●
SEE NOTE 1	1A	●	●	●	●	●	●
2	2	●	●	●	●	●	●
SEE NOTE 2	3	●	●	●	●	●	●
SEE NOTE 2	3A	●	●	●	●	●	●
SEE NOTE 2	4	●	●	●	●	●	●
SEE NOTE 2	4	●	●	●	●	●	●
SEE NOTE 2	5	●	●	●	●	●	●
SEE NOTE 3	6	●	●	●	●	●	●
SEE NOTE 3	7	●	●	●	●	●	●

RESTRICTIONS NOTES:
 1. OP-STAND 1A IS CLOSED WHEN OP-STAND 1 IS IN USE.
 2. OP-STANDS 3, 3A, 4 AND 5 ARE CLOSED DURING WORK SECTION 3 CONSTRUCTION.
 3. OP-STAND 6 IS RESTRICTED TO TEMPORARY STOP BAR AS NOTED IN TABLE.

GENERAL REQUIREMENTS:

OPERATIONAL REQUIREMENTS

- CONTRACTOR SHALL CONTROL AND BE RESPONSIBLE FOR CONTRACTOR'S PERSONNEL / SUBCONTRACTORS.
- ALL CONTRACTOR'S VEHICLES REQUIRED ON AIRSIDE FOR CONSTRUCTION ACTIVITIES SHALL BE EQUIPPED WITH 360 DEGREE FLASHING AMBER BEACON.
- ALL CONTRACTOR'S PERSONNEL / SUB-CONTRACTORS ARE REQUIRED TO HAVE TEMPORARY RESTRICTED AREA PASSES WHILE ON AIRSIDE.
- AIRSIDE ESCORT (A.E.) WILL BE PROVIDED BY THE AIRPORT. IT IS THE CONTRACTOR'S RESPONSIBILITY TO COORDINATE AND SCHEDULE THE A.E. PROVIDE 72 HOURS NOTICE FOR SCHEDULING THE A.E. CONTACT THE PRINCE GEORGE AIRPORT'S SECURITY OFFICE.
- CONTRACTOR SHALL PROVIDE THE ACCESS CONTROL GUARD (ACG). ACG IS REQUIRED FOR ALL TIMES THE AIRSIDE ACCESS GATE IS UNLOCKED. THE PRINCE GEORGE AIRPORT WILL PROVIDE TRAINING FOR THE CONTRACTOR'S ACGS PRIOR TO COMMENCEMENT OF CONSTRUCTION.
- CONTRACTOR'S CONSTRUCTION SAFETY SHALL MEET WORKSAFE BC REGULATIONS AND ADVISE AND PROTECT PERSONNEL FROM NOISE AND POTENTIAL JET BLAST / PROP WASH OF ACTIVE AIRCRAFT OPERATIONS.
- ALL AIRPORT PAVEMENT SURFACES TO BE KEPT CLEAN OF CONSTRUCTION DEBRIS AND F.O.D. CONTRACTOR IS RESPONSIBLE TO MAINTAIN & PROVIDE CLEAN PAVEMENT SURFACES.
- NO SMOKING ALLOWED ON AIRSIDE.
- ALL F.O.D. POTENTIAL ITEMS AND GARBAGE MUST BE CONTAINED TO PREVENT FLYAWAY AND THEN DISPOSED OFF-SITE AT THE END OF EACH WORK SHIFT.
- CONTRACTOR TO ARRANGE FOR SHUT DOWN AND LOCKOUT ELECTRICAL SYSTEMS PRIOR TO ANY SUBSURFACE WORK WITHIN 5M OF AIRPORT ELECTRICAL INFRASTRUCTURE. CONTRACTOR MUST RECEIVE PRIOR APPROVAL FROM THE AIRPORT IN ORDER TO SHUT DOWN ANY AIRPORT ELECTRICAL FACILITIES. CONTRACTOR MUST COORDINATE WITH THE AIRPORT'S ELECTRICAL CONTRACTOR IN ORDER TO SCHEDULE ANY ELECTRICAL CIRCUIT SHUTDOWNS AND START-UPS THAT MAY AFFECT ANY AIRPORT ELECTRICAL OR COMMUNICATION FACILITIES.
- ANY INTERRUPTION OF ELECTRICAL SYSTEMS OR NAVIGATIONAL AIDS REQUIRES A MINIMUM 72 HOURS PRIOR NOTICE AND A SPECIFIC NOTAM.
- READ AND COMPLY WITH THE PCO DOCUMENT IN THE SPECIFICATIONS THAT ACCOMPANIES THIS DRAWING.

WORK SECTION 3 - DAYTIME WORK (07:00 - 19:00):

SCOPE OF WORK:
 REMOVE EXISTING CONCRETE (FULL DEPTH AND/OR PARTIAL DEPTH) TO SUBGRADE ELEVATIONS, INCLUDING REMOVAL OFF-SITE, CONSTRUCTION OF NEW CONCRETE PANELS OR PARTIAL DEPTH REPAIRS, AND TEMPORARY TAPE AND PERMANENT PAINT MARKINGS ON APRON 1

OPERATIONAL REQUIREMENTS

- INSTALL SECURE, ENCLOSED 1.8M HIGH TEMPORARY MODULOK FENCING AROUND CONSTRUCTION AREA FOR DURATION OF CONCRETE CONSTRUCTION. INSTALL STEADY BURNING RED LIGHTS ON TEMPORARY FENCING. AIRPORT WILL SUPPLY THE SOLAR RED LIGHTS.
- ALL CONTRACTOR'S PERSONNEL / SUBCONTRACTORS SHALL BE ESCORTED BY THE A.E. FOR ALL WORK ON AIRSIDE.
- CONTRACTOR'S PERSONNEL TO BE MADE AWARE OF NORMAL AIRCRAFT AND VEHICLE MOVEMENTS OCCURRING ALONGSIDE THE WORK AREA.

WORK RESTRICTIONS:

- CONTRACTOR MUST CONTROL DUST.
- CONTRACTOR MUST MAINTAIN A CLEAN, FOD FREE CONSTRUCTION SITE AND ACCESS ROUTE.
- NO PILES ALLOWED ABOVE EXISTING GRADES.

AIRCRAFT OPERATIONAL CHANGES REQUIRED:

- SPECIAL OPERATIONS NOTICE NOTIFYING AIRPORT USERS OF CONSTRUCTION ACTIVITIES ON APRON 1.
- CLOSURE OF GATES 3, 3A, 4 AND 5 FOR THE DURATION OF WORK IN THIS SECTION.
- MAKE GROUND MARSHALLERS AWARE OF CHANGES TO AIRCRAFT PERMITTED AND TEMPORARY STOP BAR LOCATIONS ON GATE 6 AND TEMPORARY LEAD-IN LINE ON GATE 4.

LEGEND:

- TEMPORARY 1.8m HIGH SECURE FENCING C/W RED LIGHTS
- DENOTES AIRCRAFT OP-STAND CLOSED 24 / 7 UNTIL SECTION / PHASE IS COMPLETE AND RETURNED TO SERVICE
- CONTRACTOR ESCORTED ACCESS ROUTE

Scale: 1:750 @ 22"x34"

NUM	DATE	DWN	CKD	APR	DESCRIPTION
0	17/03/27				A.E. ISSUED FOR TENDER
REV	DATE	APR			DESCRIPTION

REVISIONS

PERMIT	DRAWING STATUS



CLIENT



REHABILITATION OF APRON 1 PCC PANELS

PLAN OF CONSTRUCTION OPERATIONS SECTION 3

PROJECT No.	OFFICE	DES	CKD	REV	DRAWING
TRN AIRP0313-01.001	Kelowna	K.S.A.	K.S.A.	0	
DATE:	SHEET No.	DWN	APP	STATUS	
October 31, 2016	4 of 10	M.E.R.	A.E.	IFT	

C2.2

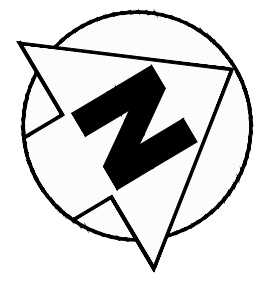

CONTRACTOR'S ESCORTED ACCESS ROUTE FOR SECTIONS 2 - 4.
CONTRACTOR TO MAINTAIN CLEAN FOD-FREE CONSTRUCTION ROUTES AT ALL TIMES.

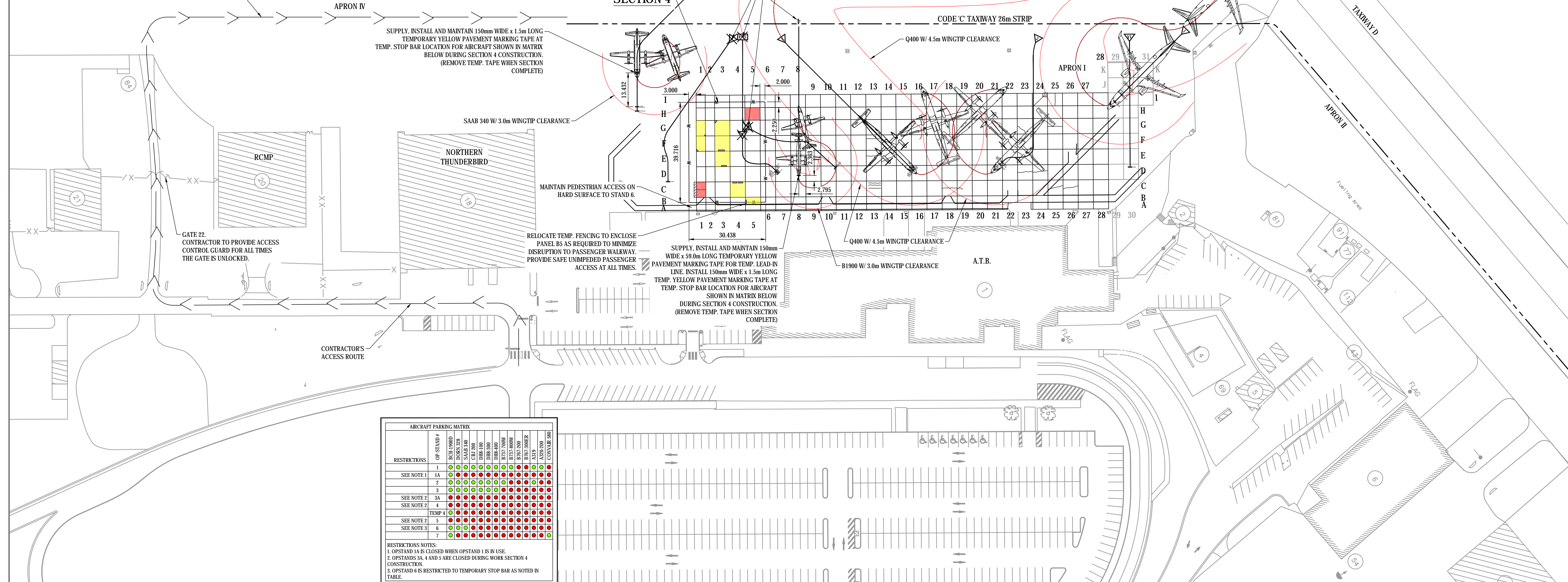

AIRCRAFT PARKING MATRIX											
RESTRICTIONS	OP-STAND #	B737-800W	SAAB 340	ATR 72-600	ATR 72-600	B737-700W	B737-800W	B737-700	B737-800ER	ATR 72-600	CONTRACTOR 300
SEE NOTE 1	1A	●	●	●	●	●	●	●	●	●	●
SEE NOTE 2	3A	●	●	●	●	●	●	●	●	●	●
SEE NOTE 2	4	●	●	●	●	●	●	●	●	●	●
SEE NOTE 2	TEMP 4	●	●	●	●	●	●	●	●	●	●
SEE NOTE 2	5	●	●	●	●	●	●	●	●	●	●
SEE NOTE 3	6	●	●	●	●	●	●	●	●	●	●
SEE NOTE 3	7	●	●	●	●	●	●	●	●	●	●

RESTRICTIONS NOTES:
 1. OP-STAND 1A IS CLOSED WHEN OPSTAND 1 IS IN USE.
 2. OPSTANDS 3A, 4 AND 5 ARE CLOSED DURING WORK SECTION 4 CONSTRUCTION.
 3. OPSTAND 6 IS RESTRICTED TO TEMPORARY STOP BAR AS NOTED IN TABLE.

GENERAL REQUIREMENTS:

OPERATIONAL REQUIREMENTS

- CONTRACTOR SHALL CONTROL AND BE RESPONSIBLE FOR CONTRACTOR'S PERSONNEL / SUBCONTRACTORS.
- ALL CONTRACTOR'S VEHICLES REQUIRED ON AIRSIDE FOR CONSTRUCTION ACTIVITIES SHALL BE EQUIPPED WITH 360 DEGREE FLASHING AMBER BEACON.
- ALL CONTRACTOR'S PERSONNEL / SUB-CONTRACTORS ARE REQUIRED TO HAVE TEMPORARY RESTRICTED AREA PASSES WHILE ON AIRSIDE.
- AIRSIDE ESCORT (A.E.) WILL BE PROVIDED BY THE AIRPORT. IT IS THE CONTRACTOR'S RESPONSIBILITY TO COORDINATE AND SCHEDULE THE A.E. PROVIDE 72 HOURS NOTICE FOR SCHEDULING THE A.E. CONTACT THE PRINCE GEORGE AIRPORT'S SECURITY OFFICE.
- CONTRACTOR SHALL PROVIDE THE ACCESS CONTROL GUARD (ACG). ACG IS REQUIRED FOR ALL TIMES THE AIRSIDE ACCESS GATE IS UNLOCKED. THE PRINCE GEORGE AIRPORT WILL PROVIDE TRAINING FOR THE CONTRACTOR'S ACG PRIOR TO COMMENCEMENT OF CONSTRUCTION.
- CONTRACTOR'S CONSTRUCTION SAFETY SHALL MEET WORKSAFE BC REGULATIONS AND ADVISE AND PROTECT PERSONNEL FROM NOISE AND POTENTIAL JET BLAST / PROW WASH OF ACTIVE AIRCRAFT OPERATIONS.
- ALL AIRPORT PAVEMENT SURFACES TO BE KEPT CLEAN OF CONSTRUCTION DEBRIS AND F.O.D. CONTRACTOR IS RESPONSIBLE TO MAINTAIN & PROVIDE CLEAN PAVEMENT SURFACES.
- NO SMOKING ALLOWED ON AIRSIDE.
- ALL F.O.D. POTENTIAL ITEMS AND GARBAGE MUST BE CONTAINED TO PREVENT FLYAWAY AND THEN DISPOSED OFF-SITE AT THE END OF EACH WORK SHIFT.
- CONTRACTOR TO ARRANGE FOR SHUT-DOWN AND LOCKOUT ELECTRICAL SYSTEMS PRIOR TO ANY SUBSURFACE WORK WITHIN 5M OF AIRPORT ELECTRICAL INFRASTRUCTURE. CONTRACTOR MUST RECEIVE PRIOR APPROVAL FROM THE AIRPORT IN ORDER TO SHUT DOWN ANY AIRPORT ELECTRICAL FACILITIES. CONTRACTOR MUST COORDINATE WITH THE AIRPORT'S ELECTRICAL CONTRACTOR IN ORDER TO SCHEDULE ANY ELECTRICAL CIRCUIT SHUTDOWNS AND START-UPS THAT MAY AFFECT ANY AIRPORT ELECTRICAL OR COMMUNICATION FACILITIES.
- ANY INTERRUPTION OF ELECTRICAL SYSTEMS OR NAVIGATIONAL AIDS REQUIRES A MINIMUM 72 HOURS PRIOR NOTICE AND A SPECIFIC NOTAM.
- READ AND COMPLY WITH THE PCO DOCUMENT IN THE SPECIFICATIONS THAT ACCOMPANIES THIS DRAWING.

WORK SECTION 4 - DAYTIME WORK (07:00 - 19:00):

SCOPE OF WORK:
 REMOVE EXISTING CONCRETE (FULL DEPTH AND/OR PARTIAL DEPTH) TO SUBGRADE ELEVATIONS, INCLUDING REMOVAL OFF-SITE, CONSTRUCTION OF NEW CONCRETE PANELS OR PARTIAL DEPTH REPAIRS, AND TEMPORARY TAPE AND PERMANENT PAINT MARKINGS ON APRON I

OPERATIONAL REQUIREMENTS

- INSTALL SECURE, ENCLOSED 1.8M HIGH TEMPORARY MODULOK FENCING AROUND CONSTRUCTION AREA FOR DURATION OF CONCRETE CONSTRUCTION. INSTALL STEADY BURNING RED LIGHTS ON TEMPORARY FENCING. AIRPORT WILL SUPPLY THE SOLAR RED LIGHTS.
- ALL CONTRACTOR'S PERSONNEL / SUBCONTRACTORS SHALL BE ESCORTED BY THE A.E. FOR ALL WORK ON AIRSIDE.
- CONTRACTOR'S PERSONNEL TO BE MADE AWARE OF NORMAL AIRCRAFT AND VEHICLE MOVEMENTS OCCURRING ALONGSIDE THE WORK AREA.

WORK RESTRICTIONS:

- CONTRACTOR MUST CONTROL DUST.
- CONTRACTOR MUST MAINTAIN A CLEAN, FOD FREE CONSTRUCTION SITE AND ACCESS ROUTE.
- NO PILES ALLOWED ABOVE EXISTING GRADES.

AIRPORT OPERATIONAL CHANGES REQUIRED:

- SPECIAL OPERATIONS NOTICE NOTIFYING AIRPORT USERS OF CONSTRUCTION ACTIVITIES ON APRON I
- CLOSURE OF GATES 3A, 4 AND 5 FOR THE DURATION OF WORK IN THIS SECTION.
- MAKE GROUND MARSHALLERS AWARE OF CHANGES TO AIRCRAFT PERMITTED AND TEMPORARY STOP BAR LOCATIONS ON GATE 6 AND TEMPORARY LEAD-IN LINE ON GATE 4.

LEGEND:

- — — — — TEMPORARY 1.8m HIGH SECURE FENCING CW RED LIGHTS
- ✕ DENOTES AIRCRAFT OP-STAND CLOSED 24 / 7 UNTIL SECTION / PHASE IS COMPLETE AND RETURNED TO SERVICE
- CONTRACTOR ESCORTED ACCESS ROUTE

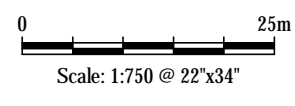

NUM	DATE	DWN	CKD	APR	DESCRIPTION
0	17/03/27			A.E.	ISSUED FOR TENDER
REV	DATE	APR			DESCRIPTION

REVISIONS

PERMIT



PROFESSIONAL SEAL

CLIENT

REHABILITATION OF APRON I PCC PANELS

PLAN OF CONSTRUCTION OPERATIONS SECTION 4

PROJECT No.	OFFICE	DES	CKD	REV	DRAWING
TRN AIRP03113-01.001	Kelowna	K.S.A.	K.S.A.	0	
DATE:	SHEET No.	DWN	APP	STATUS	
October 31, 2016	5 of 10	M.E.R.	A.E.	IFT	

C2.3

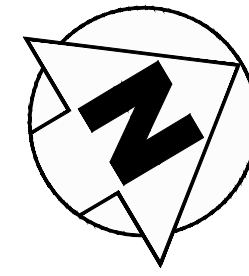

FULL DEPTH PANEL REPLACEMENT (TYP):
 - FULL DEPTH SAWCUT 150mm FROM ALL EX. JOINTS TO PROTECT ADJACENT PANELS AND KEYWAYS FOR CONCRETE REMOVAL
 - PROTECT, GRADE, WATER, COMPACT EX. UNDERLYING BASE GRAVEL
 - INSTALL NEW EPOXY COATED DOWELS ADJACENT ALL EX. PANELS
 - CONSTRUCT NEW PCC PANEL TO MATCH EX. PANEL THICKNESS OF EITHER 300mm OR 350mm
 - SAWCUT / SEAL NEW PCC JOINTS
 SEE DETAIL DWG C4.0

REPAIR (TYP):
 CUT TO 80-100mm DEPTH WITHIN REPAIR AREA AND INSPECT UNDERLYING CONCRETE
 REPAIR PRODUCT, CURE, PROTECT EQUIRED

JOINT SEAL REPLACEMENT (TYP):
 - REMOVE ALL EX. JOINT SEALANT AND BACKER ROD
 - SAWCUT EX. JOINTS
 - CLEAN EX. JOINTS
 - INSTALL NEW BACKER ROD AND SEALANT

APRON I

JACK HAMMER TOP 100mm OF MH CONCRETE TOP. PROTECT EX. SURROUNDING HMAC. SAWCUT HMAC IF NECESSARY TO PROVIDE SMOOTH VERTICAL EDGE. AND CONSTRUCT NEW STEEL RE-INFORCED CONCRETE TOP. PREVENT DELETERIOUS MATERIALS FROM ENTERING THE STORM SEWER SYSTEM. SEE DETAILS DWG C5.0.

PROTECT EX. HMAC / PCC LOAD TRANSFER RAMP
 SEE DETAIL DWG C4.0

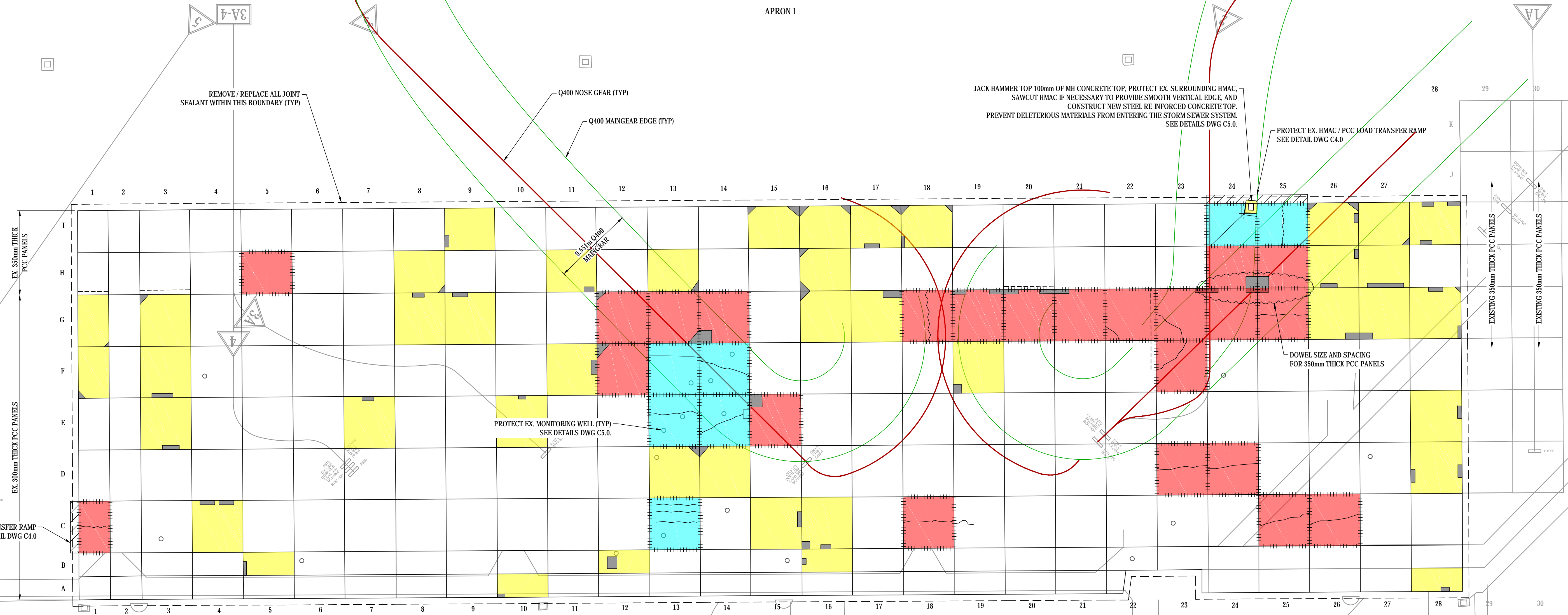

NOTES:
 1. CONTRACTOR TO CONTAIN ALL DELETERIOUS MATERIALS, CONCRETE SLUDGE FROM ENTERING THE STORM SEWER SYSTEM.

LEGEND:
 - - - EX. PCC CRACK
 - - - EX. PCC PANEL EDGE HIGH <10mm

■ FULL DEPTH, FULL PANEL REPLACEMENT C/W EPOXY COATED DOWELS
 ■ PARTIAL DEPTH REPAIR OF LOCALIZED AREA OF PANEL
 ▨ PROTECT EX. HMAC / PCC LOAD TRANSFER RAMP
 ■ FULL DEPTH, FULL PANEL REPLACEMENT C/W EPOXY COATED DOWELS AND SYNTHETIC MICROFIBRE CONCRETE MIX

Scale: 1:250 @ 22'x34'

NUM	DATE	DWN	CKD	APR	DESCRIPTION
0	17/03/27	A.E.			ISSUED FOR TENDER
		REV	DATE	APR	DESCRIPTION

REVISIONS

A.T.B.



CLIENT



REHABILITATION OF APRON I PCC PANELS

CONCRETE PANEL REHABILITATION PLAN

PROJECT No. TRN AIRP03113-01.001	OFFICE Kelowna	DES K.S.A.	CKD K.S.A.	REV 0	DRAWING C3.0
DATE October 31, 2016	SHEET No. 6 of 10	DWN M.E.R.	APP A.E.	STATUS IFT	

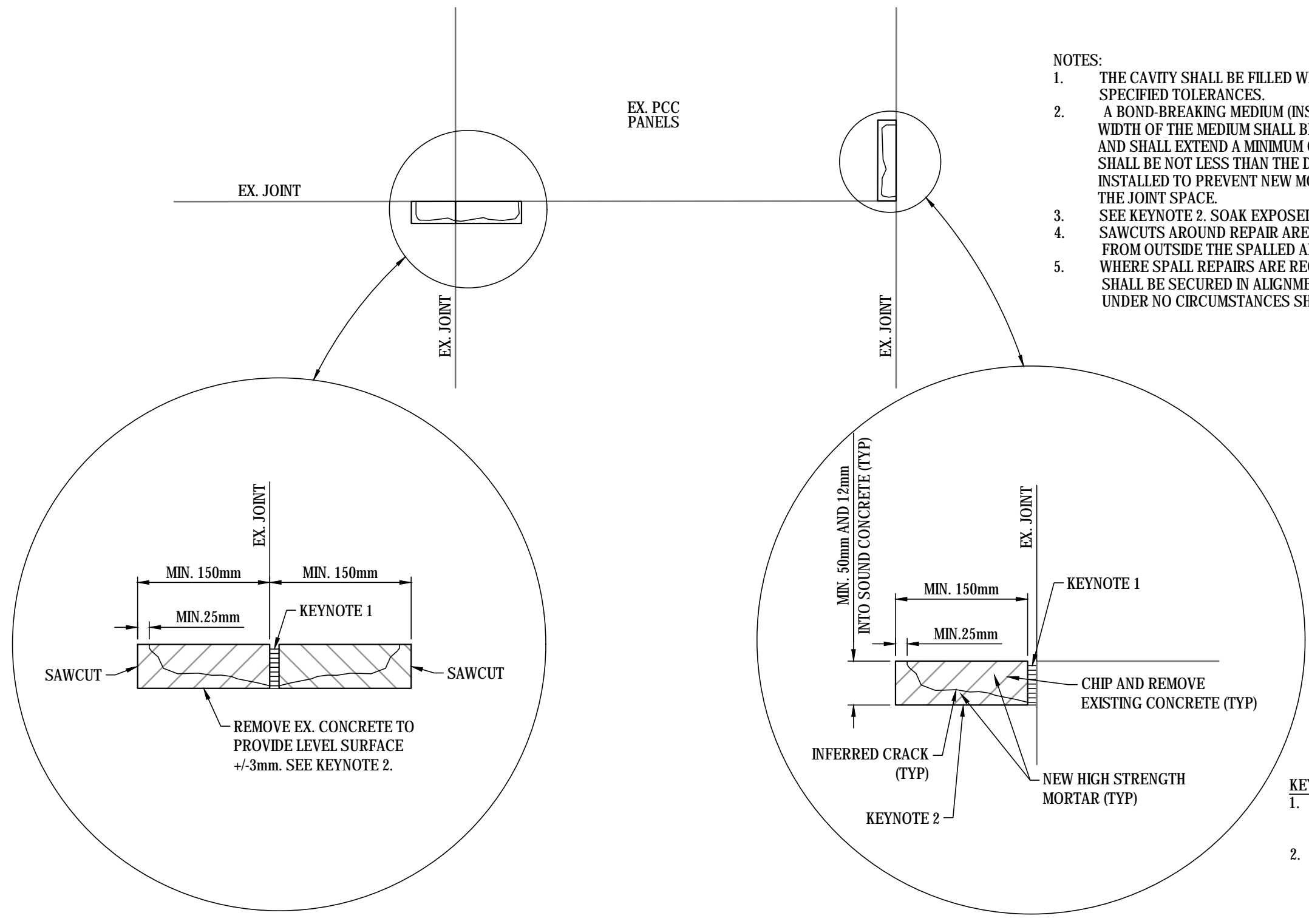

- NOTES:
1. THE CAVITY SHALL BE FILLED WITH 35MPa CONCRETE TO THE PAVEMENT SURFACE AND WITHIN SPECIFIED TOLERANCES.
 2. A BOND-BREAKING MEDIUM (INSERT) IS REQUIRED TO MAINTAIN EXISTING JOINTS AND WORKING CRACKS. WIDTH OF THE MEDIUM SHALL BE EQUAL TO THE WIDTH OF THE EXISTING GAP AT THE JOINT OR CRACK AND SHALL EXTEND A MINIMUM OF 25mm ON EACH END OF THE PREPARED CAVITY. DEPTH OF THE MEDIUM SHALL BE NOT LESS THAN THE DEPTH OF NEW PATCH MATERIALS. THE MEDIUM SHOULD BE NEATLY INSTALLED TO PREVENT NEW MORTAR OR CONCRETE FROM BY-PASSING THE MEDIUM AND ENTERING THE JOINT SPACE.
 3. SEE KEYNOTE 2. SOAK EXPOSED CAVITY WITH WATER TO INSPECT FOR CRACKS.
 4. SAWCUTS AROUND REPAIR AREAS SHALL BE MINIMUM 150mm FROM ANY JOINT EDGE AND MINIMUM 25mm FROM OUTSIDE THE SPALLED AREA.
 5. WHERE SPALL REPAIRS ARE REQUIRED ON EACH SIDE OF A JOINT, A NONFLEXIBLE MEDIUM (INSERT) SHALL BE SECURED IN ALIGNMENT WITH THE JOINT AFTER BREAKING OUT THE SPALLED CONCRETE. UNDER NO CIRCUMSTANCES SHALL A SPALL REPAIR BRIDGE A JOINT.

- KEYNOTES:
1. SEPARATING MEDIUM (INSERT) REMOVE AFTER REPAIR COMPLETE AND INSTALL BACKER ROD TO PROVIDE JOINT SEALANT DEPTH AS SHOWN ON DETAIL 'C'.
 2. DEPTH OF CAVITY TO BE MINIMUM 50mm DEPTH AND 12mm INTO SOUND CONCRETE.

A REPAIR OF CONCRETE PANELS (SPALL) DETAIL
C3.0 N.T.S.

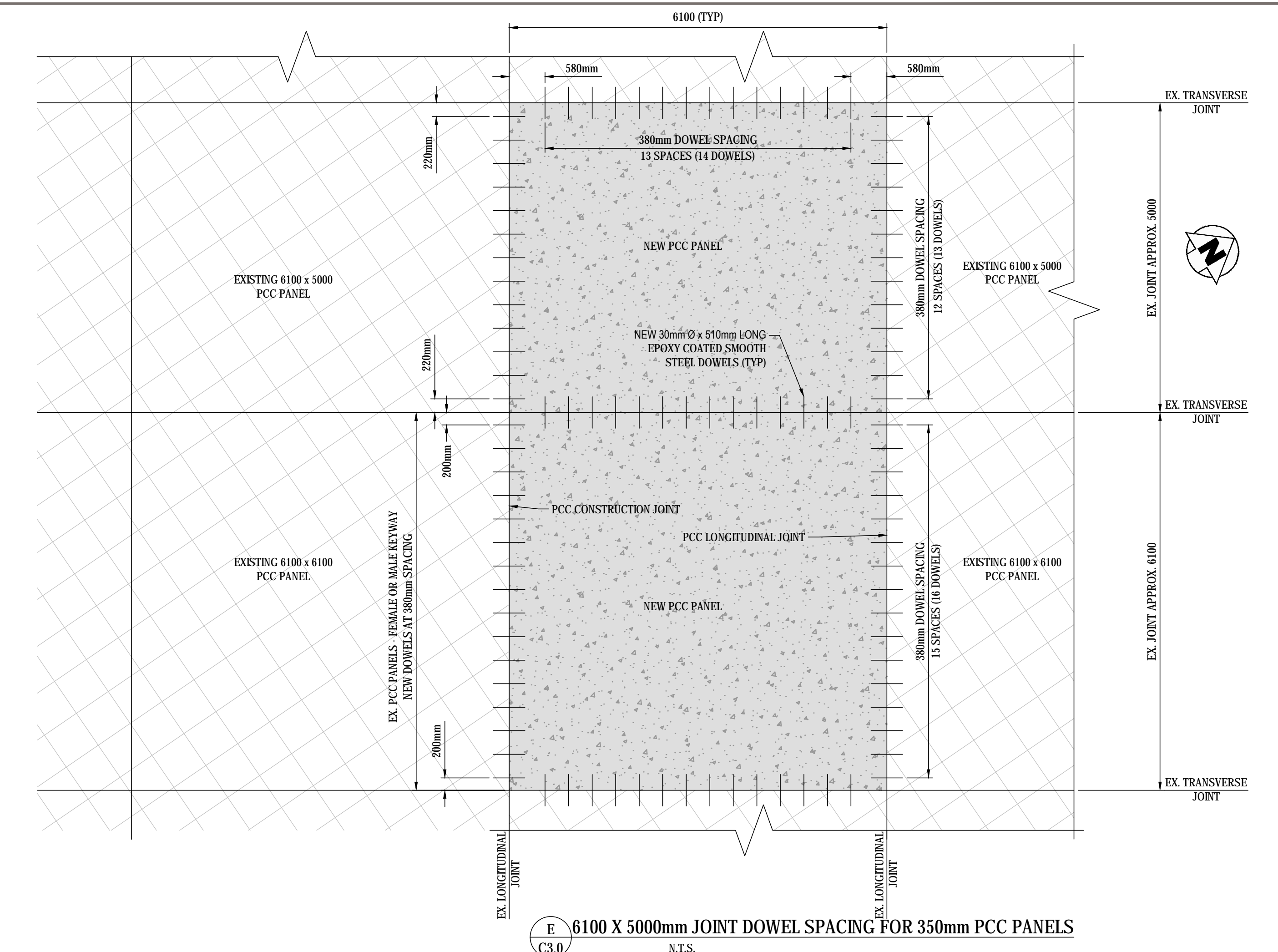

E 6100 X 5000mm JOINT DOWEL SPACING FOR 350mm PCC PANELS
C3.0 N.T.S.

TABLE		
300mm THICK PCC PANEL	25mm Ø x 480mm LONG @ 305mm C.C.	
350mm THICK PCC PANEL	30mm Ø x 510mm LONG @ 380mm C.C.	

JOINT DIMENSIONS				
T	B	C	D	E
300	120	60	30	45
350	140	70	35	52.5

B = T x 0.4
C = T x 0.2
D = T x 0.1
E = T x 0.15

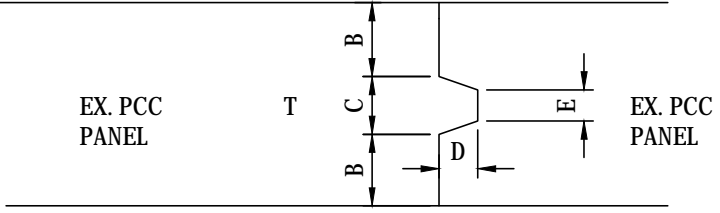

F EX. PCC PANEL KEYWAY DETAIL
C3.0 N.T.S.

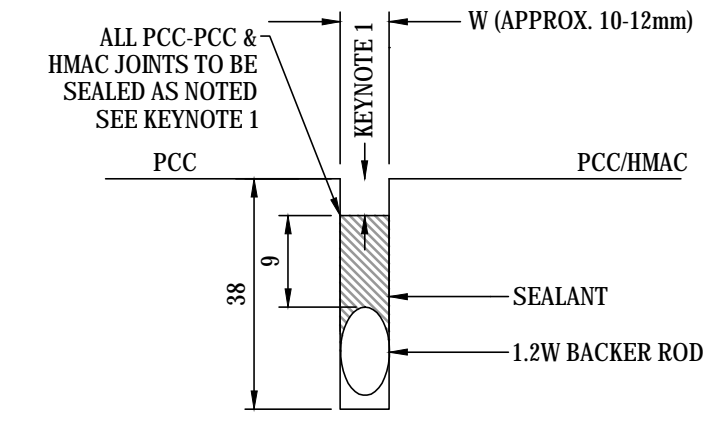

- KEYNOTES:
1. SANDBLAST EX. JOINT AFTER REMOVAL OF ALL EVIDENCE OF SEALANT. BACKER ROD FROM JOINT TO PROVIDE CLEAN VERTICAL SURFACES AS APPROVED BY CONSULTANT.

D REHABILITATION OF EXISTING JOINT DETAIL
N.T.S.

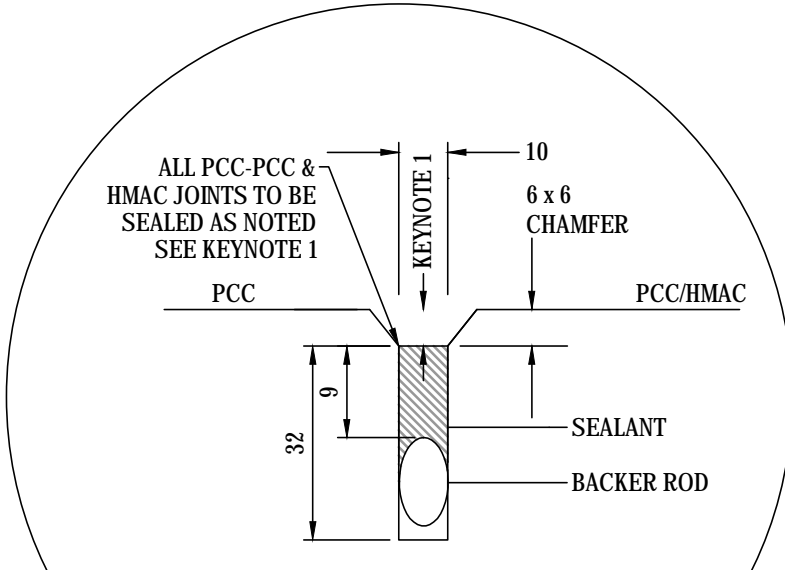

C NEW JOINT DETAIL
N.T.S.

- KEYNOTES:
1. SAWCUT NEW JOINT. SEAL WITH APPROVED SEALANT AND AS PER SEALANT MANUFACTURERS SPECIFICATIONS.
 2. DIAMETER AND LENGTH OF DRILL HOLE FOR EPOXY COATED SMOOTH DOWELS AS RECOMMENDED BY EPOXY MANUFACTURER. ENSURE NO VOIDS.
 3. EPOXY COATED SMOOTH DOWEL BAR. PAINT ANY EXPOSED STEEL WITH EPOXY. Wipe dowel clean of debris and grease free end of smooth dowel immediately prior to placing new concrete. Where dowels are set in baskets and / or both ends are free, alternate the grease on free end.
 4. PROTECT EX. PCC PANEL EDGES / MALE / FEMALE KEYWAY DURING REMOVALS OF CONCRETE PANELS. APPLY DE-BONDING AGENT TO FEMALE KEYWAY IMMEDIATELY PRIOR TO CONCRETE PLACEMENT.
 5. PROTECT EX. PCC PANELS AND UNDERLYING COMPACTED GRANULAR GRAVELS FROM BEING UNDERMINED.
 6. APPLY APPROVED RELEASE AGENT TO ALL FORMS.

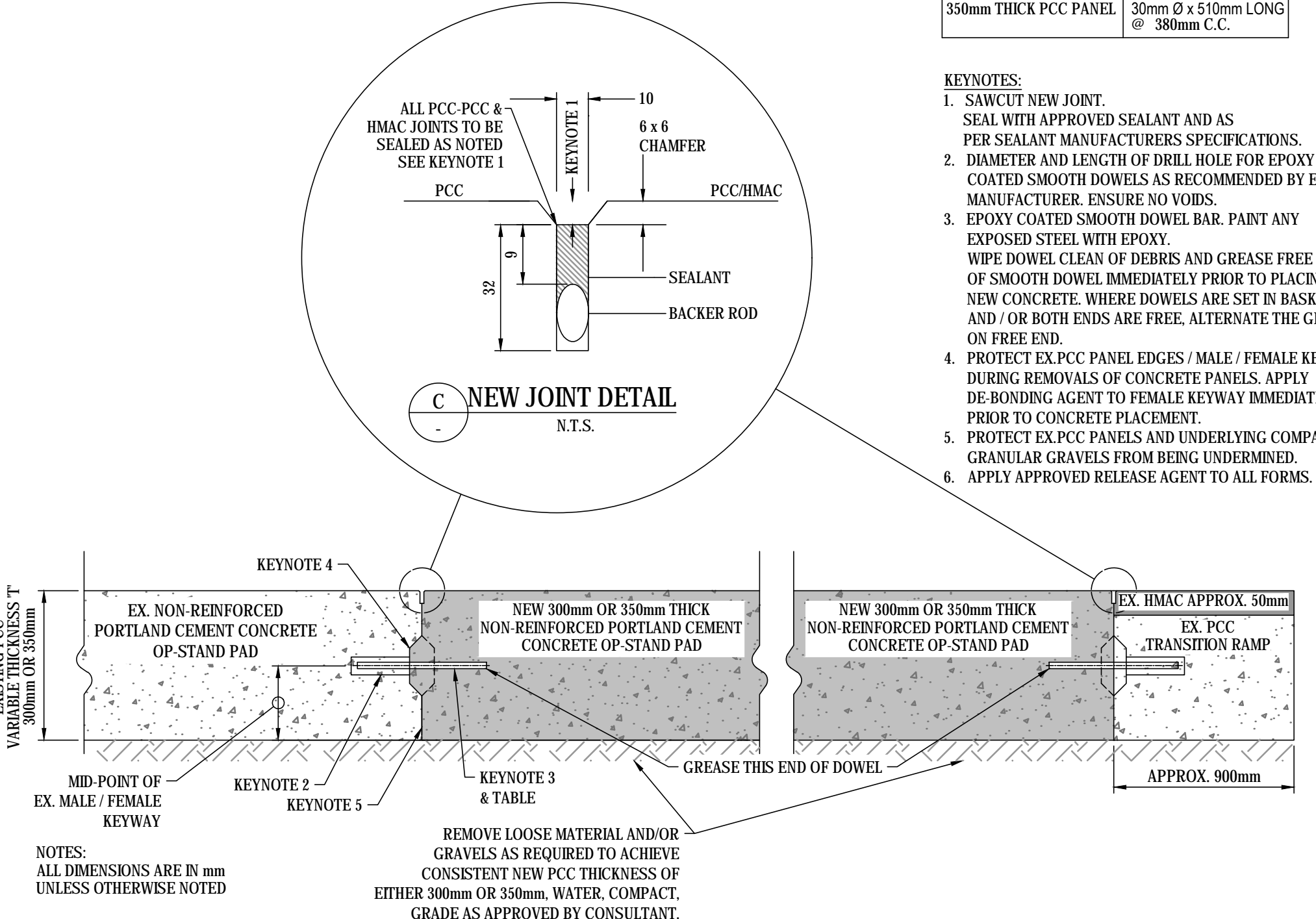

B NEW PCC TO EX. PCC JOINT CONSTRUCTION JOINT
C3.0 N.T.S.

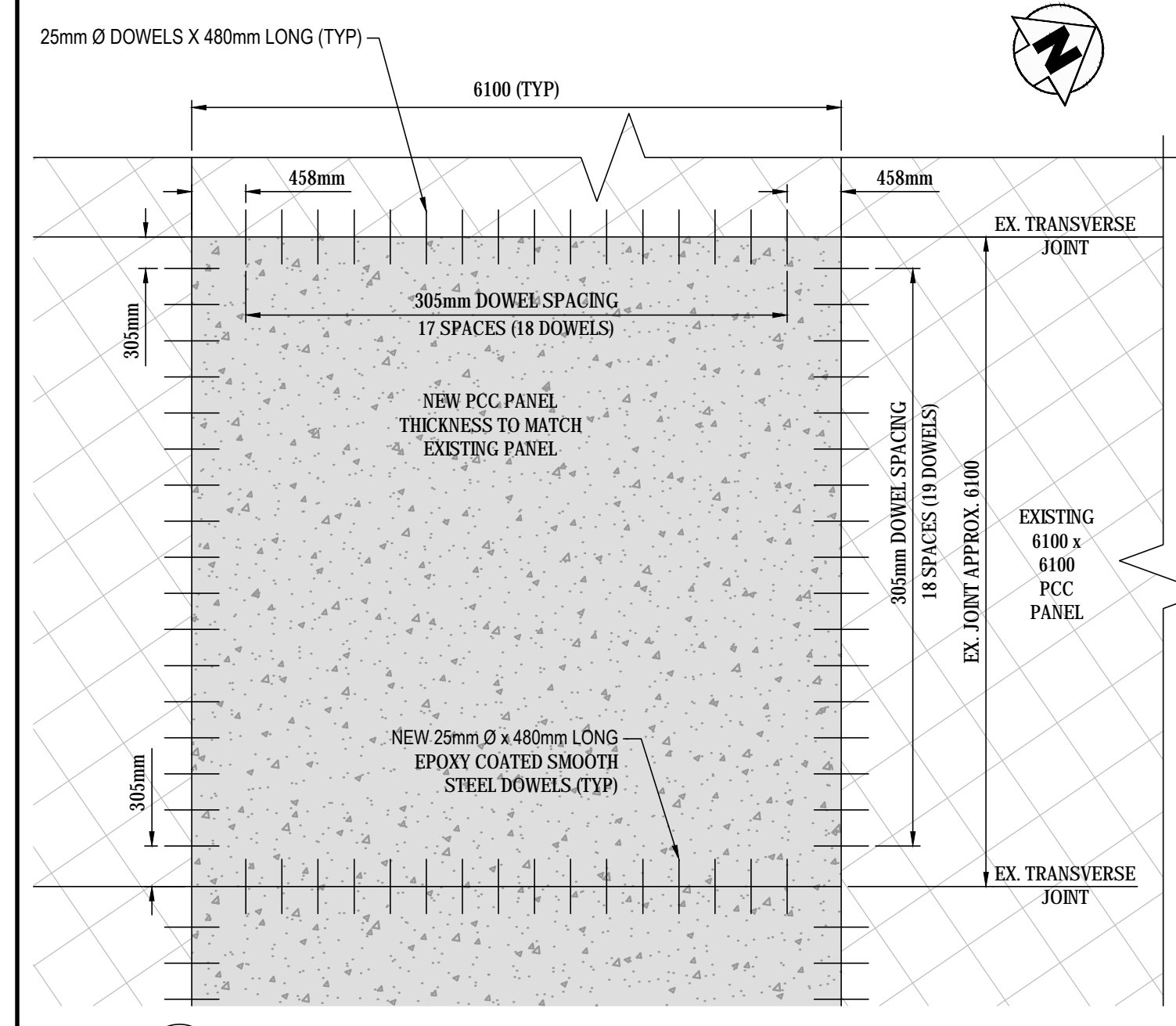

E 6100 X 6100mm JOINT DOWEL SPACING FOR 300mm P.C.C. PANELS
C3.0 N.T.S.

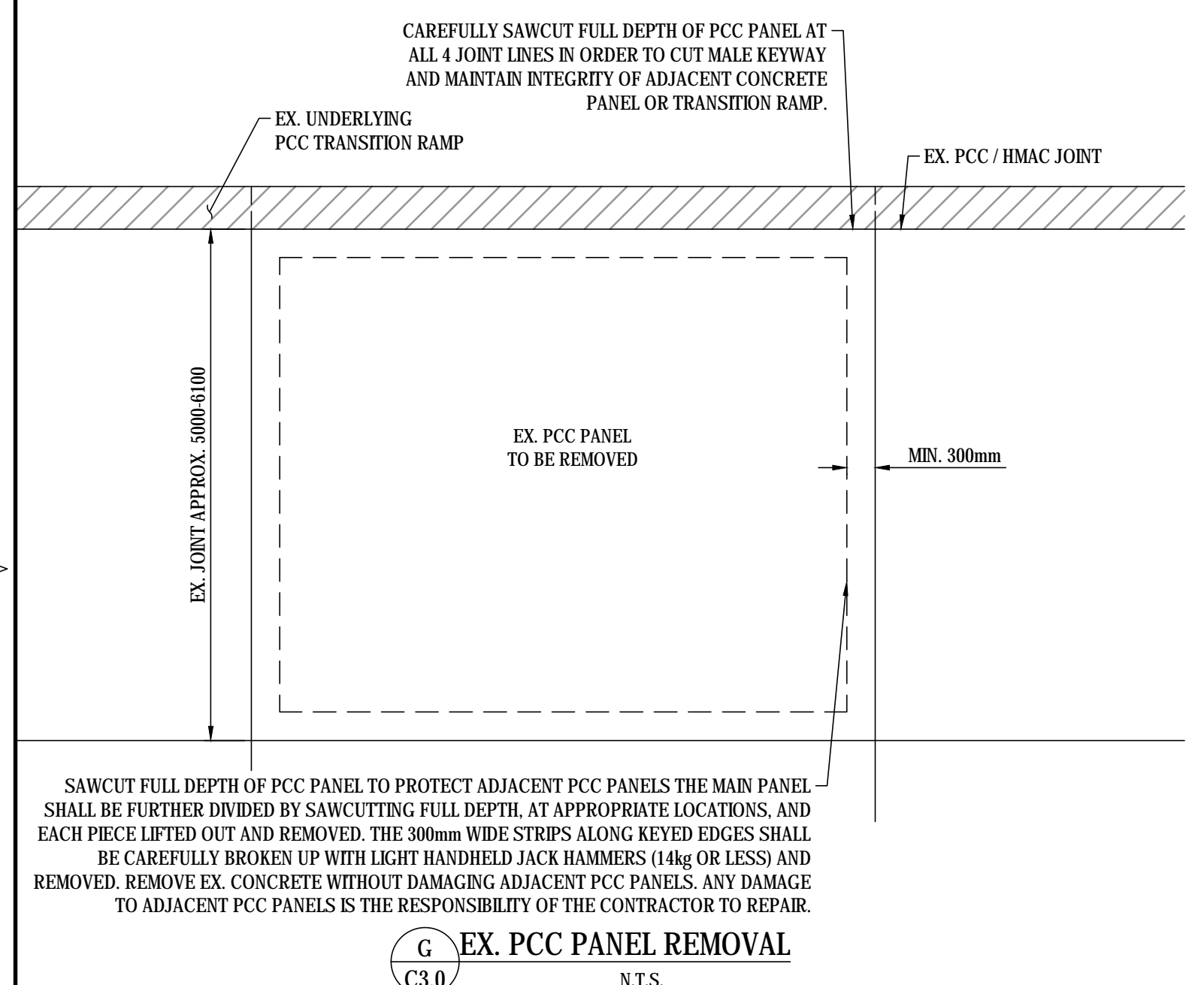

G EX. PCC PANEL REMOVAL
C3.0 N.T.S.

NUM	DATE	DWN	CKD	APR	DESCRIPTION	NUM	DATE	DWN	CKD	APR	DESCRIPTION
0	17/03/27				A.E. ISSUED FOR TENDER	0	17/03/27				A.E. ISSUED FOR TENDER

PERMIT

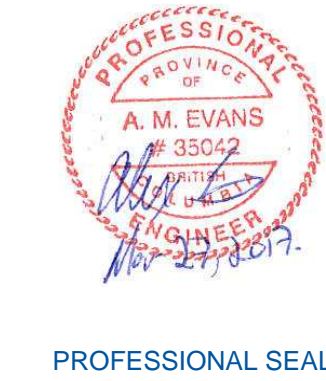

REHABILITATION OF APRON I PCC PANELS					
CONCRETE PANEL REHABILITATION DETAILS I					
PROJECT No.	OFFICE	DES	CKD	REV	DRAWING
TRN AIRP03113-01.001	Kelowna	K.S.A.	K.S.A.	0	
DATE:	SHEET No.	DWN	APP	STATUS	
October 31, 2016	7 of 10	M.E.R.	A.E.	IFT	C4.0

Y:\Projects\2016\AIRPORT\03113-01\CONCRETE\DETAILS\DWG\C4.0 REHABILITATION OF APRON I PCC PANELS.DWG (BY: RIONIKI, MKK) March 27, 2017 - 11:16:28 AM (BY: RIONIKI, MKK)

DOWEL BASKETS PINNED TO GRAVEL GRADE TO HOLD DOWELS IN PLACE

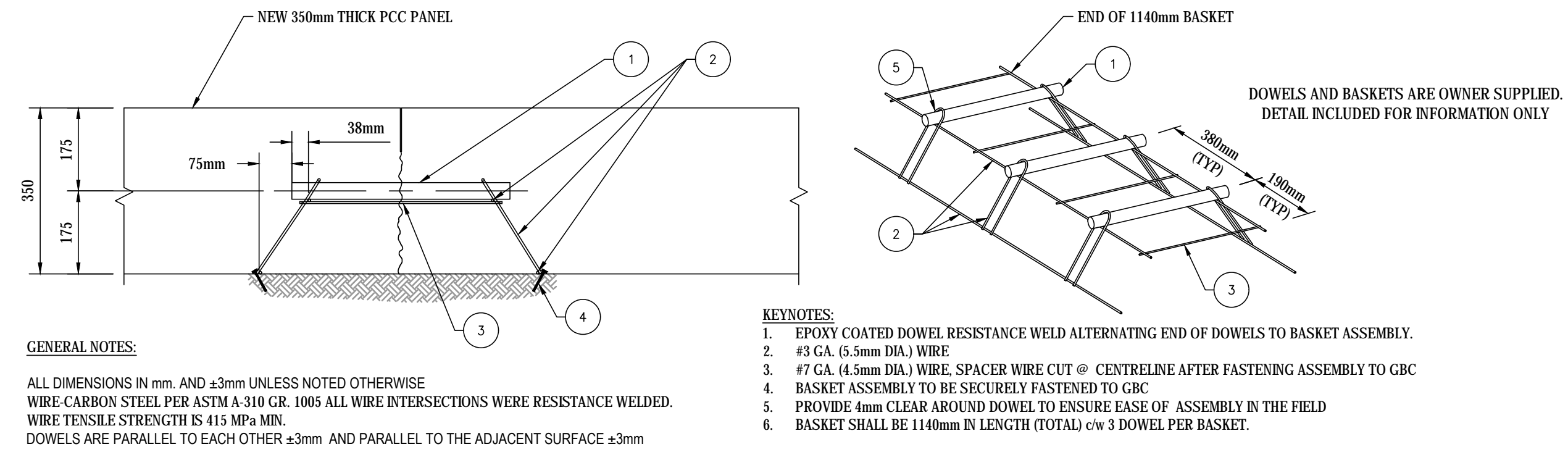

A DOWEL BASKET DETAIL FOR 350mm THICK PCC PANELS
 C3.0 N.T.S.

DOWEL BASKETS PINNED TO GRAVEL GRADE TO HOLD DOWELS IN PLACE

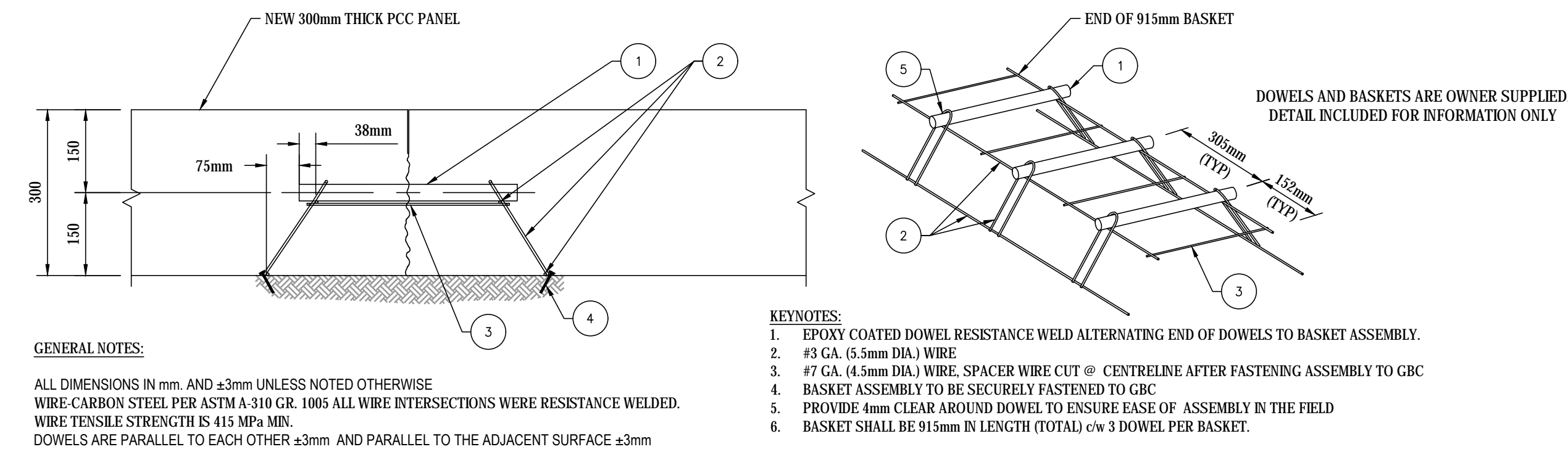

B DOWEL BASKET DETAIL FOR 300mm THICK PCC PANELS
 C3.0 N.T.S.

W:\Projects\ELM\B03\AIRPORT\313-CONC\Drawings\ITEN\AIRPORT13 YXS C4.1-CONC DETAILS 2.dwg [C4.1] March 27, 2017 - 11:28:31 am (BY: HUDNISKI, MKE)

NUM	DATE	DWN	CKD	APR	DESCRIPTION
0	17/03/27				A.E. ISSUED FOR TENDER

NUM	DATE	APR	DESCRIPTION

PERMIT



CLIENT

TETRA TECH

REHABILITATION OF APRON I PCC PANELS

CONCRETE PANEL REHABILITATION DETAILS II

PROJECT No.	OFFICE	DES	CKD	REV	DRAWING
TRN AIRP03113-01.001	Kelowna	K.S.A.	K.S.A.	0	
DATE:	SHEET No.	DWN	APP	STATUS	C4.1
October 31, 2016	8 of 10	M.E.R.	A.E.	IFT	

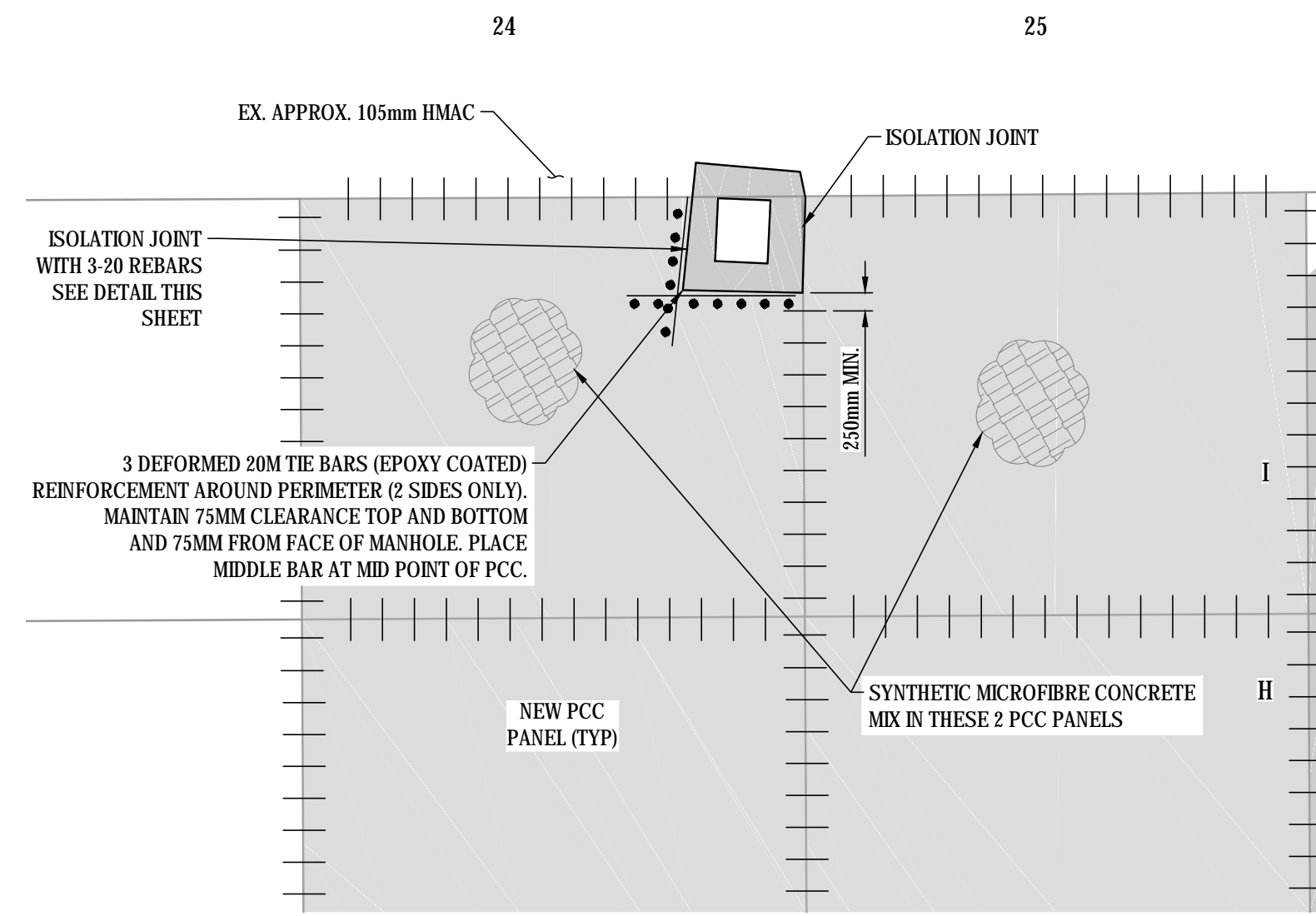

H REINFORCEMENT AROUND EXISTING STORM MANHOLE
SCALE = 1 : 75

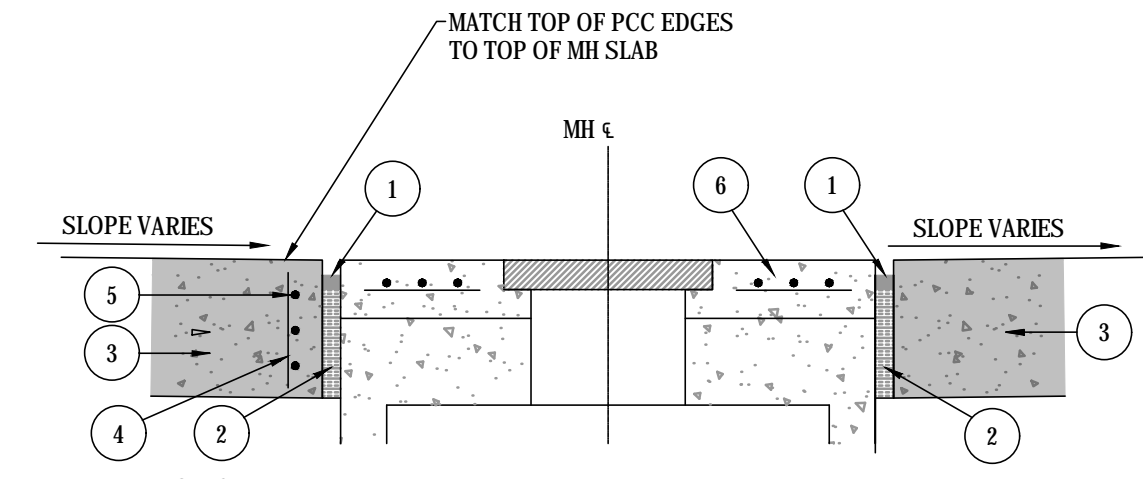

- NOTES:
ALL DIMENSIONS ARE IN mm UNLESS OTHERWISE NOTED
- 1 JOINT / SEALANT - SEE DWG C4.0 DETAIL 'B'
 - 2 12.5mm NON-EXTRUDING PRE-MOULDED COMPRESSIBLE MATERIAL EXPANSION JOINT TO EXTEND FULL DEPTH OF CONCRETE. INSTALL BETWEEN CONCRETE AND STRUCTURE ONLY.
 - 3 NEW 350mm PCC
 - 4 VERTICAL DEFORMED 20M TIE BARS (EPOXY COATED) SPACED AS REQUIRED. MAINTAIN 75mm CLEARANCE TOP AND BOTTOM. (2 SIDES ONLY)
 - 5 3 DEFORMED 20M TIE BARS (EPOXY COATED) REINFORCEMENT AROUND PERIMETER. MAINTAIN 75mm CLEARANCE TOP AND BOTTOM AND 75mm FROM FACE OF MANHOLE. PLACE MIDDLE BAR AT MID POINT OF 350mm PCC.
 - 6 JACK HAMMER TOP 100mm OF MH CONCRETE TOP. PROTECT EX. SURROUNDING HMA. SAWCUT IF NECESSARY TO PROVIDE SMOOTH VERTICAL EDGE, AND CONSTRUCT NEW STEEL RE-INFORCED CONCRETE TOP. PREVENT DELETERIOUS MATERIALS FROM ENTERING THE STORM SEWER SYSTEM.
- 1 MANHOLE AND ISOLATION JOINT DETAIL (MH BLOCKOUT)**
N.T.S.

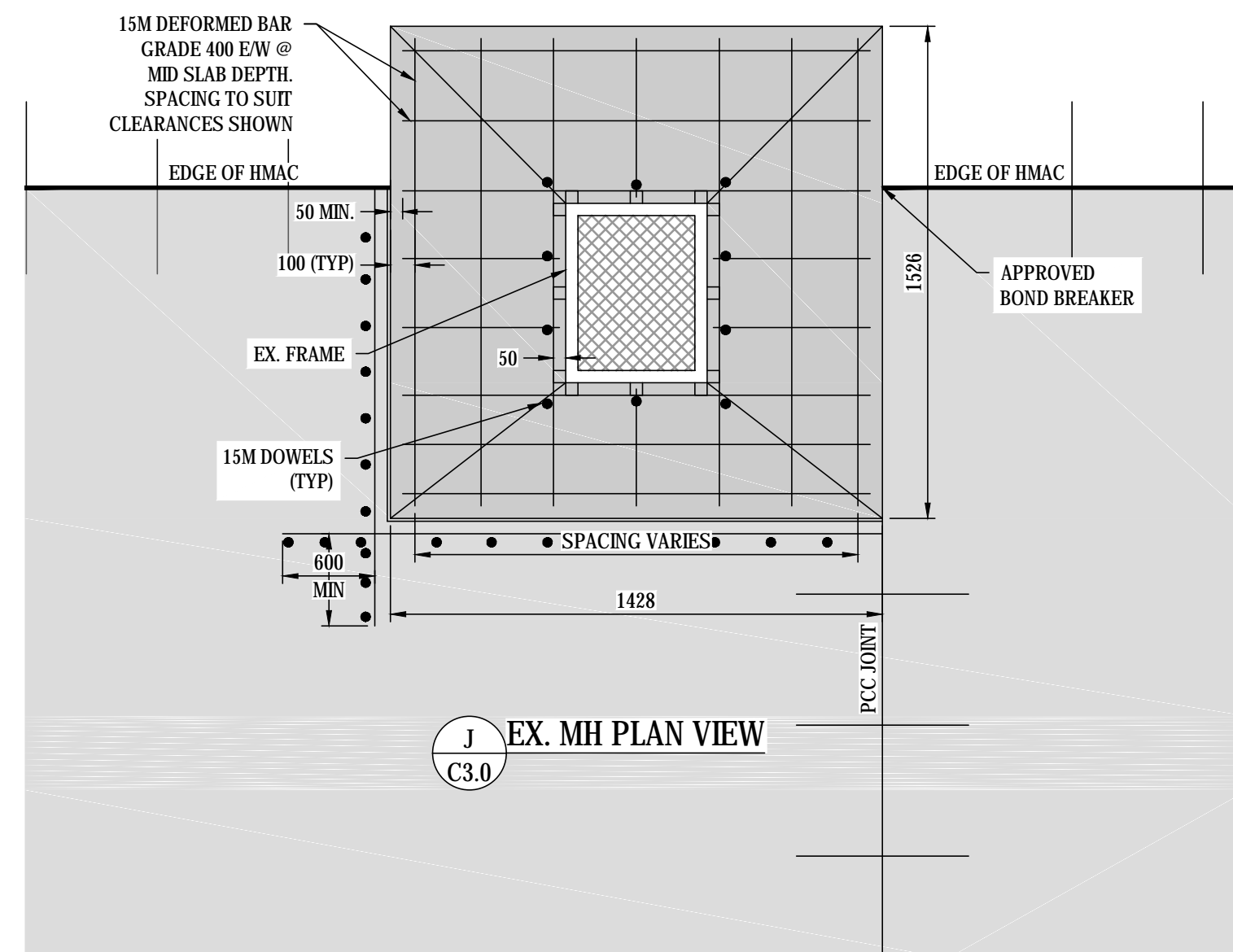

J EX. MH PLAN VIEW
C3.0

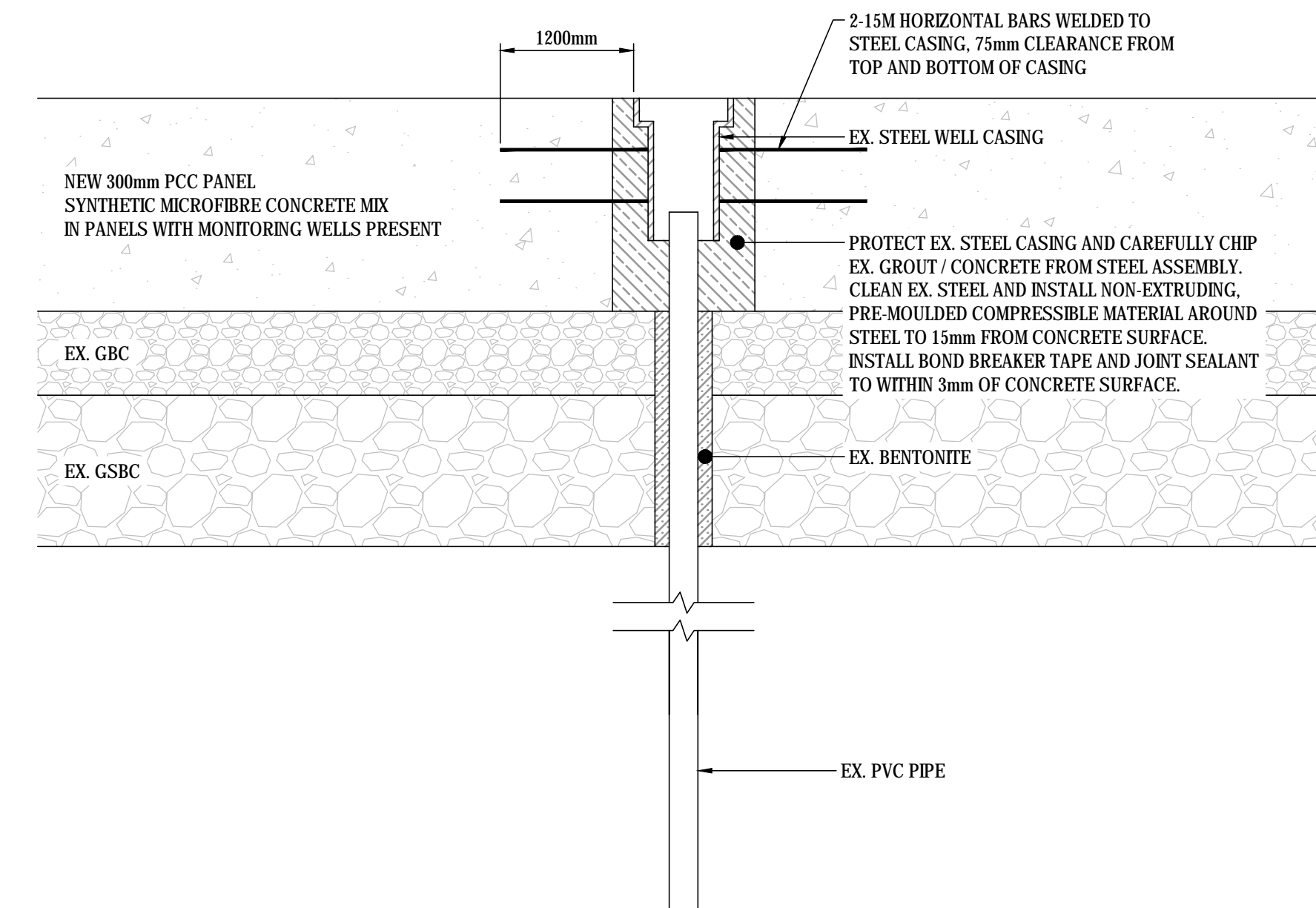

K EX. MONITORING WELL DETAIL
C3.0

W:\Projects\2017\112203\112203.dwg (C3.0) March 27, 2017 - 11:22:03 am (BY: SUDHISHI_M) [C3.0] March 27, 2017 - 11:22:03 am (BY: SUDHISHI_M)

NUM	DATE	DWN	CKD	APR	DESCRIPTION
0	17/03/27				A.E. ISSUED FOR TENDER

NUM	DATE	APR	DESCRIPTION

PERMIT PROFESSIONAL SEAL

CLIENT

YXS
prince george airport authority

TETRA TECH

REHABILITATION OF APRON PCC PANELS

MANHOLE CONCRETE TOP DETAILS

PROJECT No. TRN AIRP03113-01.001	OFFICE Kelowna	DES KSA	CKD K.S.A.	REV 0	DRAWING C5.0
DATE October 31, 2016	SHEET No. 9 of 10	DWN M.E.R.	APP A.E.	STATUS IFT	

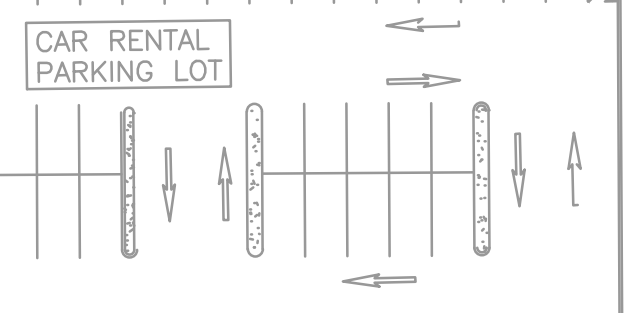
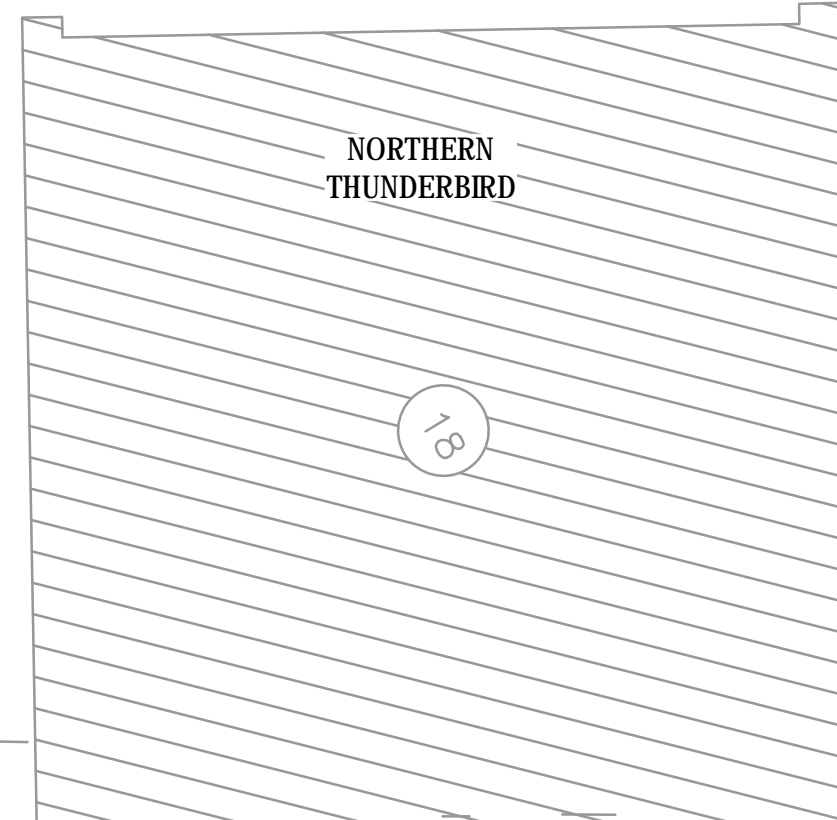
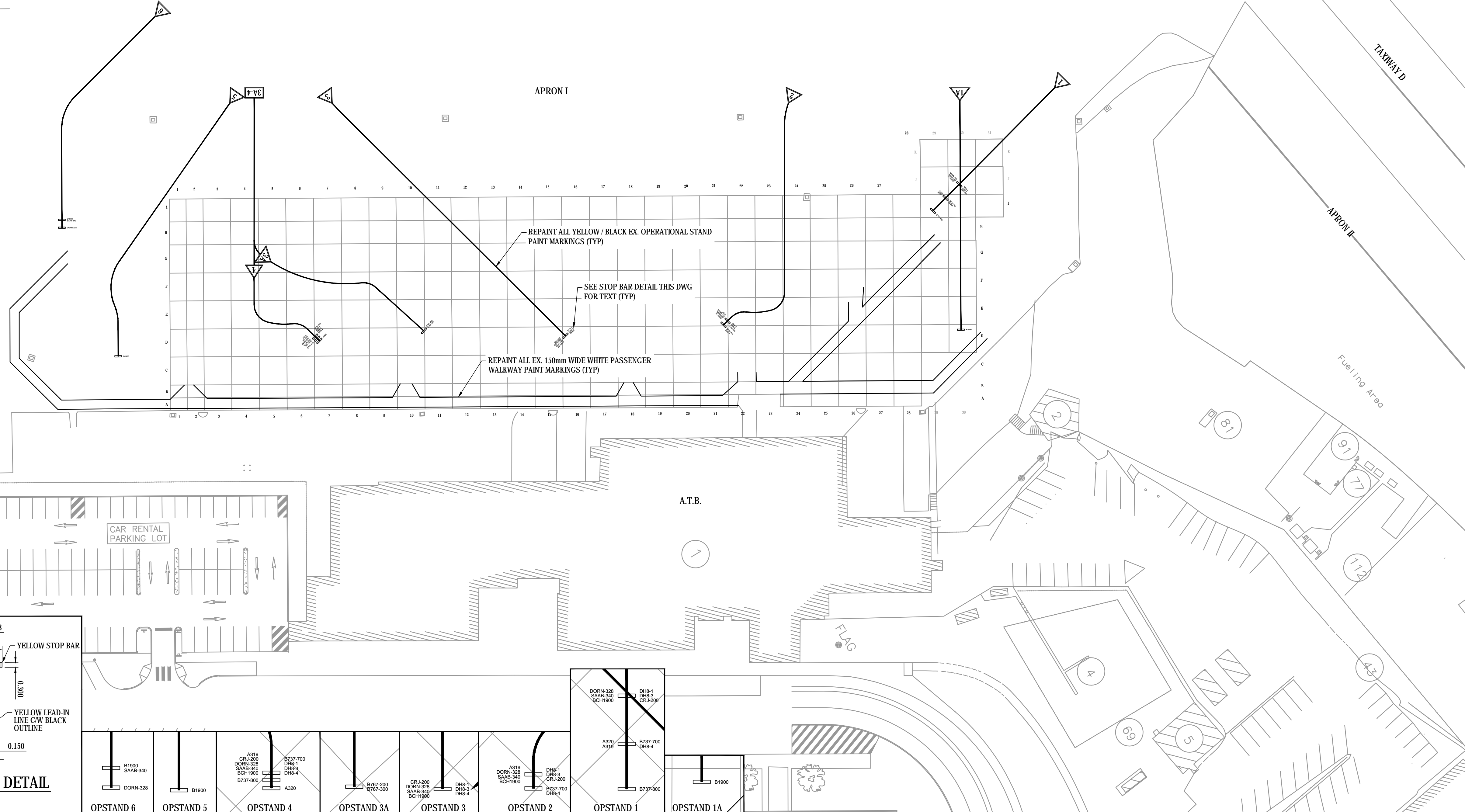
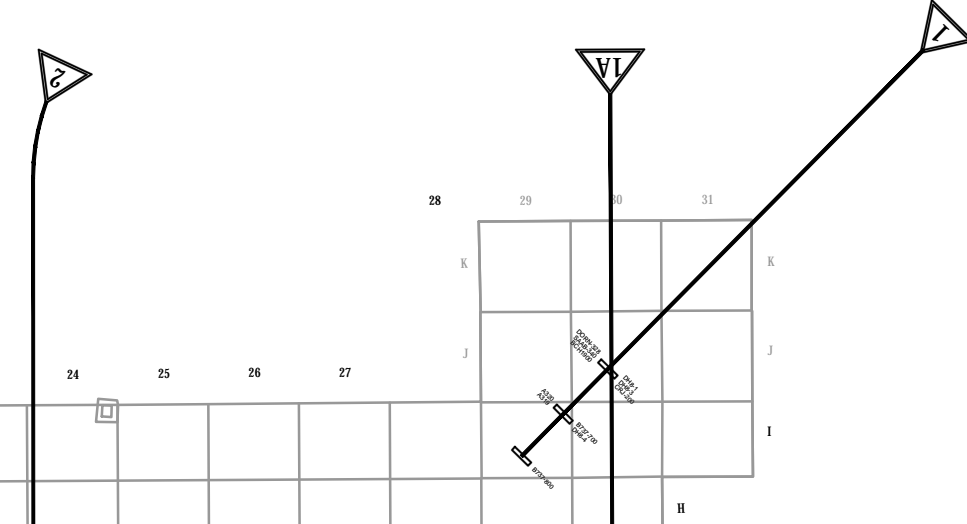
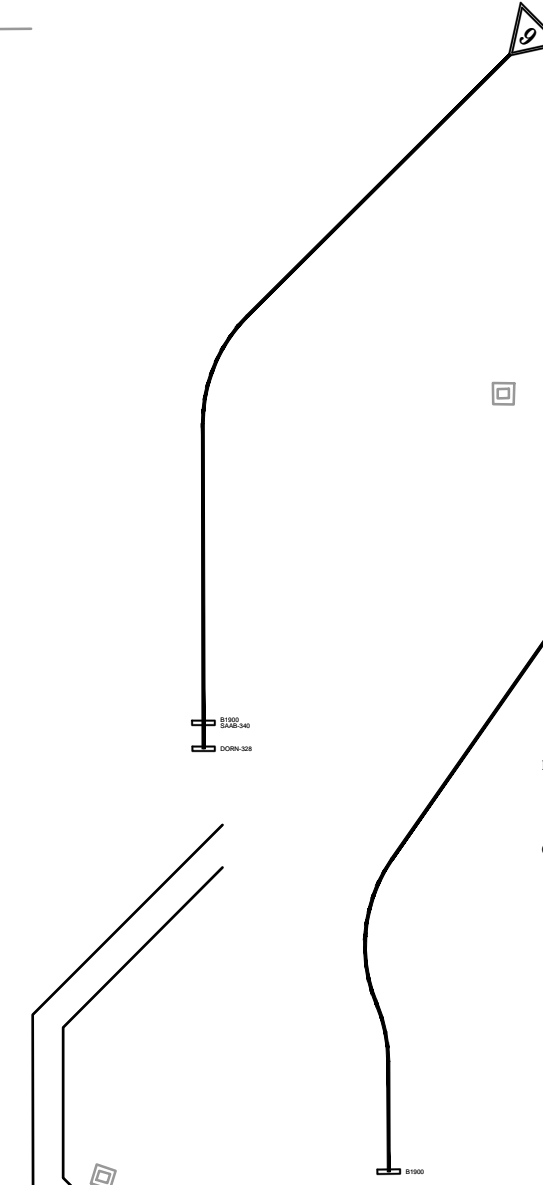
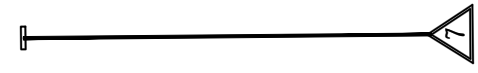
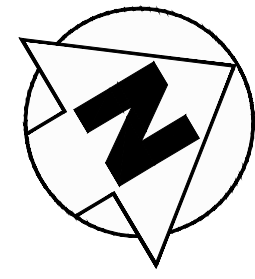

A.T.B.

FLAG

TAXIWAY D

APRON I

Fueling Area

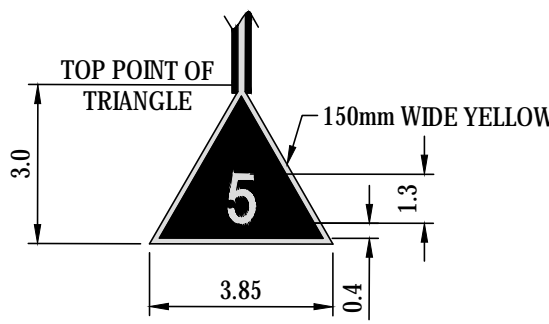

OP-stand DESIGNATOR MARKING

1:200

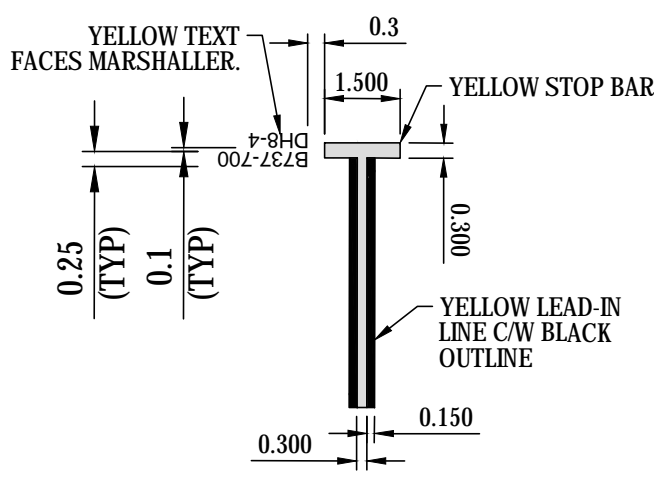

STOP BAR DETAIL

1:150

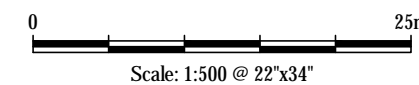
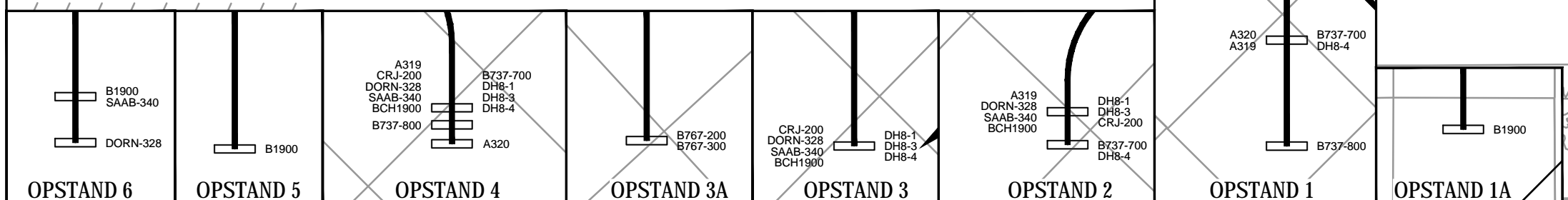

Scale: 1:500 @ 22"x34"

NUM	DATE	DWN	CKD	APR	DESCRIPTION
0	17/03/27	A.E.			ISSUED FOR TENDER
REV	DATE	APR			DESCRIPTION

DRAWING STATUS

PERMIT

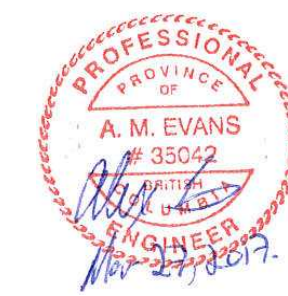

PROFESSIONAL SEAL



REHABILITATION OF APRON I PCC PANELS

PAINT MARKING PLAN

PROJECT No.	OFFICE	DES	CKD	REV	DRAWING
TRN.AIRP03113-01.001	Kelowna	K.S.A.	K.S.A.	0	
DATE:	SHEET No.	DWN	APP	STATUS	C6.0
October 31, 2016	10 of 10	M.E.R.	A.E.	IFT	

\\p\proj\air\ELU\03113-01\CAD\Design\TRN.AIRP03113-01\03113-01-001.dwg (C:\) March 27, 2017, 9:29:38 am BY: RUMISKA, MME